

Topper Lane conceptual example

ELEVATION

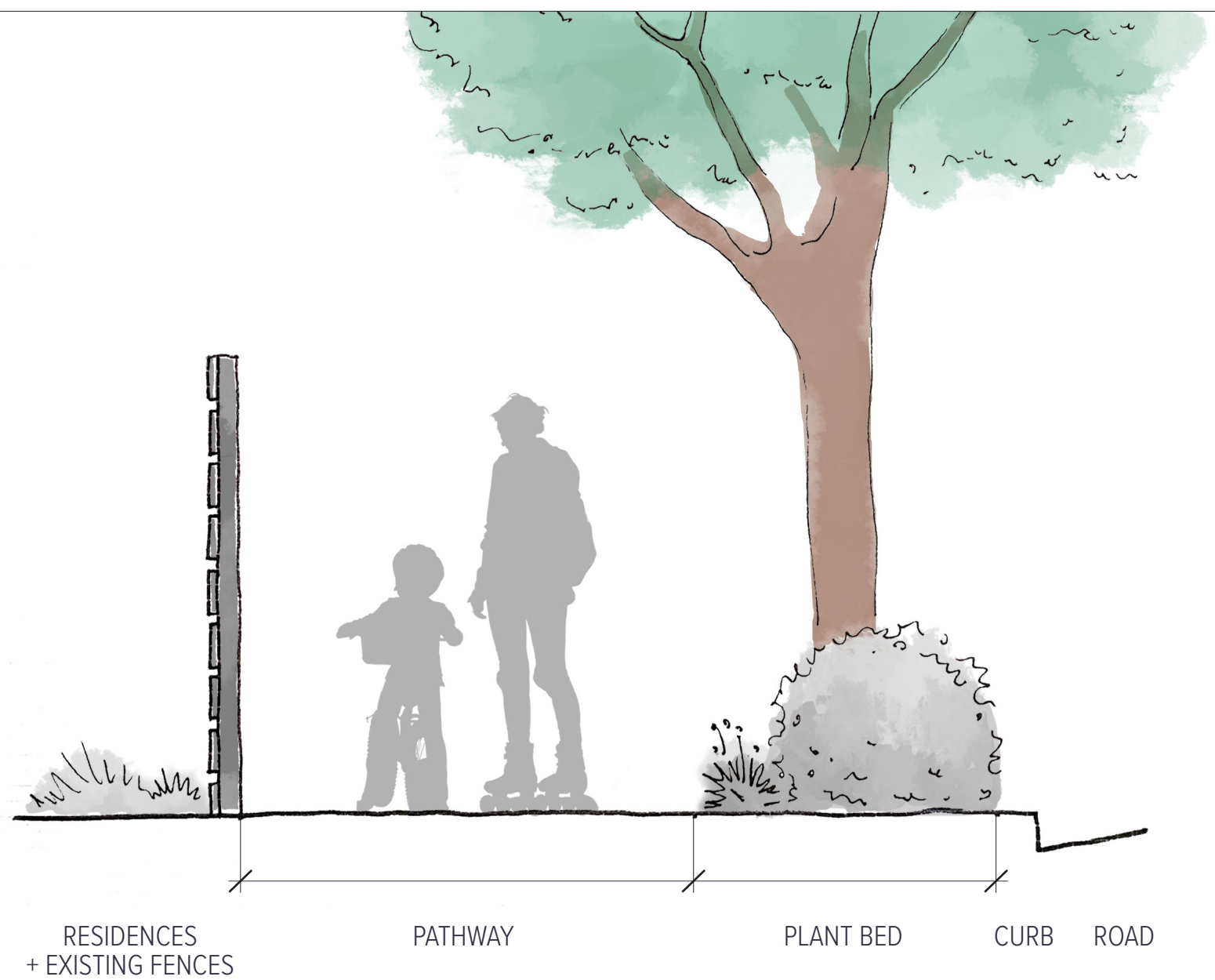

PLAN

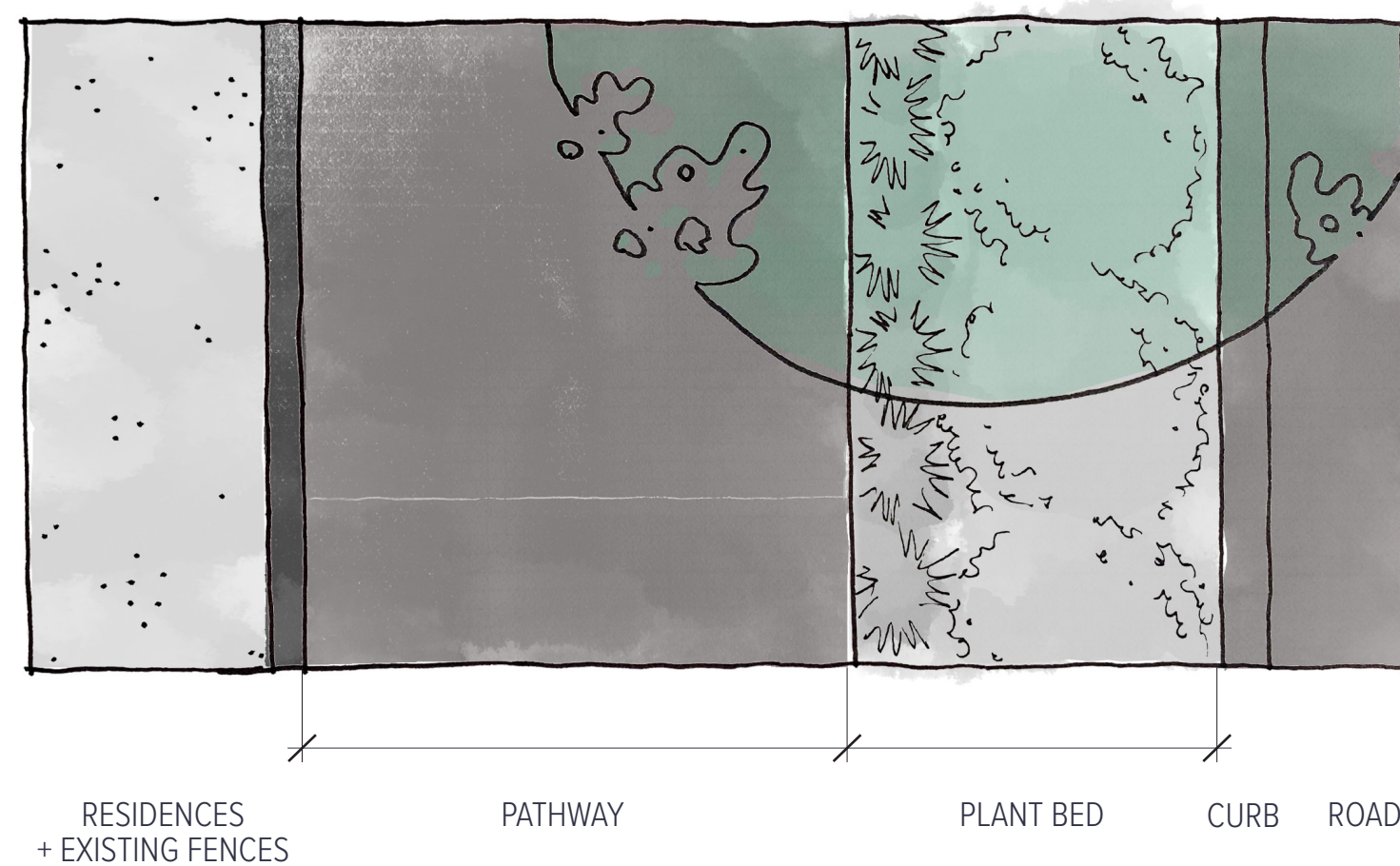

NOTE: EXAMPLE ELEVATION/PLAN SHOWN. ACTUAL LAYOUT TO VARY BY LOCATION. SEE CONCEPT BOARDS FOR FURTHER DETAILS.

Tree Considerations for proposed pathway

GOALS

- Maximize privacy for residents
- Enhance neighborhood aesthetics
- Shade pathway for pedestrians
- Avoid potential pathway obstructions
- Ease of maintenance

NOTE: EXAMPLES SHOWN REPRESENT POTENTIAL TREES. SPECIES TO BE DETERMINED IN A LATER DESIGN PHASE .

IMPLEMENTATION TO MEET GOALS

- Species will be selected to be: fast-growing, ornamental (flowering or seasonal interest), and well-suited for narrow planting areas
- Trees will reach at least 15 feet in height at maturity



WESTERN REDBUD (*CERCIS OCCIDENTALIS*) BLOOMS IN LATE WINTER, SHOWY FALL FOLIAGE



STRAWBERRY TREE (*ARBUTUS 'MARINA'*) HAS REDDISH PEELING BARK, SPRING FLOWER CLUSTERS AND ORNAMENTAL FRUIT



CHINESE PISTACHE (*PISTACIA CHINENSIS*) TREES HAVE VIBRANT FALL COLOR AND AN OPEN HABIT



DESERT WILLOW (*CHILOPSIS LINEARIS*) HAVE BRIGHT SPRING BLOOMS AND ARE EXTREMELY DROUGHT TOLERANT

Topper Lane

conceptual example

ELEVATION

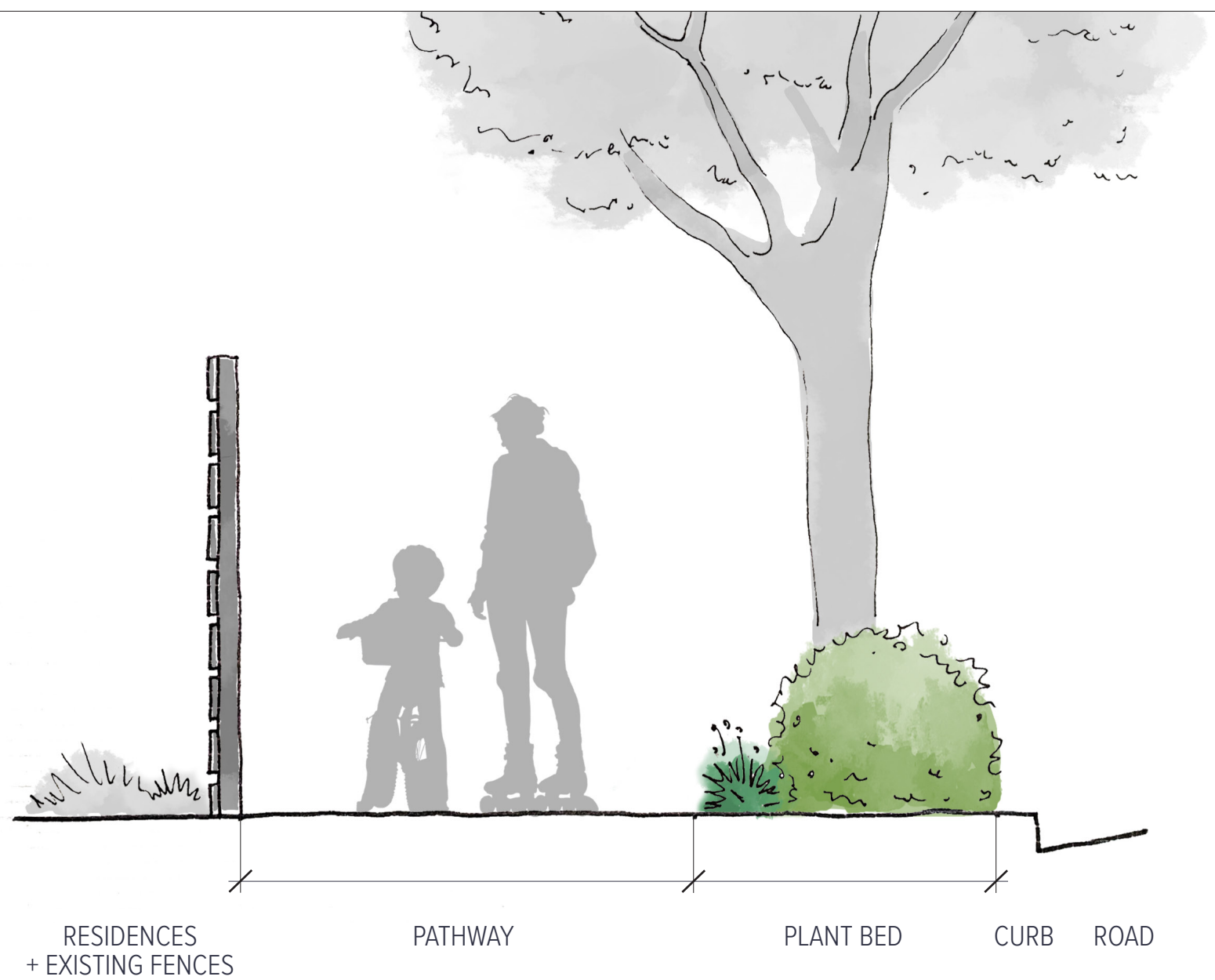

PLAN

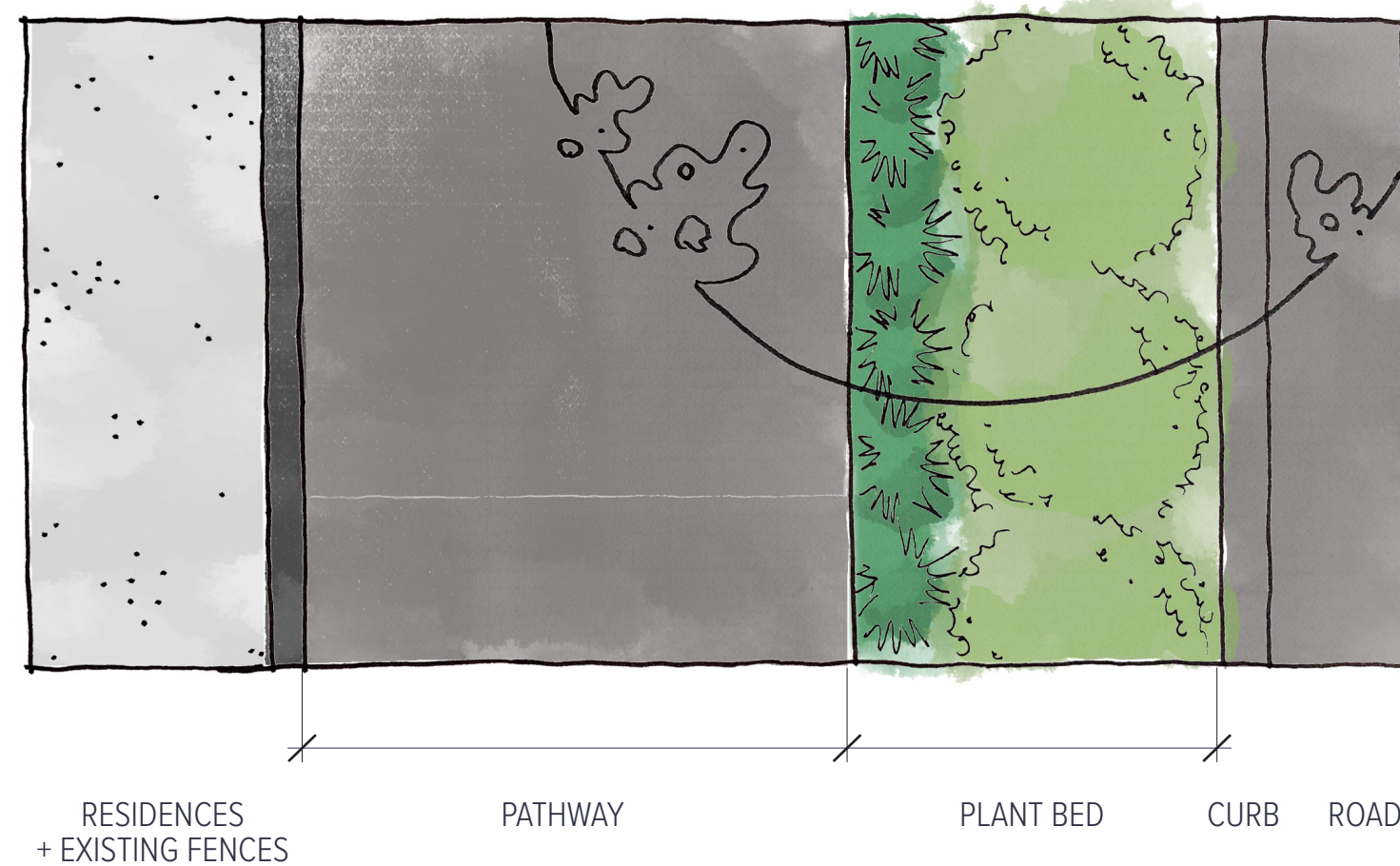

NOTE: EXAMPLE ELEVATION/PLAN SHOWN. ACTUAL LAYOUT TO VARY BY LOCATION. SEE CONCEPT BOARDS FOR FURTHER DETAILS.

Shrub + Groundcover Considerations

for proposed pathway

GOALS

- Maximize privacy for residents
- Enhance neighborhood aesthetics
- Avoid potential pathway obstructions
- Ease of maintenance

IMPLEMENTATION TO MEET GOALS

- Efforts will be made to install mature specimens
- Plants will be low maintenance + drought tolerant
- Plants will be spaced to avoid obstructing path
- For narrow areas, mulch or gravel may be used

NOTE: EXAMPLES SHOWN REPRESENT POTENTIAL PLANTS. SPECIES TO BE DETERMINED IN A LATER DESIGN PHASE.



DEERGRASS (MUHLENBERGIA RIGENS) IS A FINELY TEXTURED CLUMPING GRASS WHICH HOLDS FLOWER STALKS THROUGH FALL



MANZANITA (ARCTOSTAPHYLOS) HAS WINTER FLOWERS + BERRY-SIZE FRUIT



CALIFORNIA LILAC (CEANOTHUS G. HORIZONTALIS) IS EXCELLENT FOR ECOSYSTEM + POLLINATORS



CALIFORNIA GRAY RUSH (JUNCUS PATENS) TOLERATES DROUGHT AND FLOOD, HOLDING ITS RIGID ARCHITECTURAL STRUCTURE

School Street

conceptual example

ELEVATION

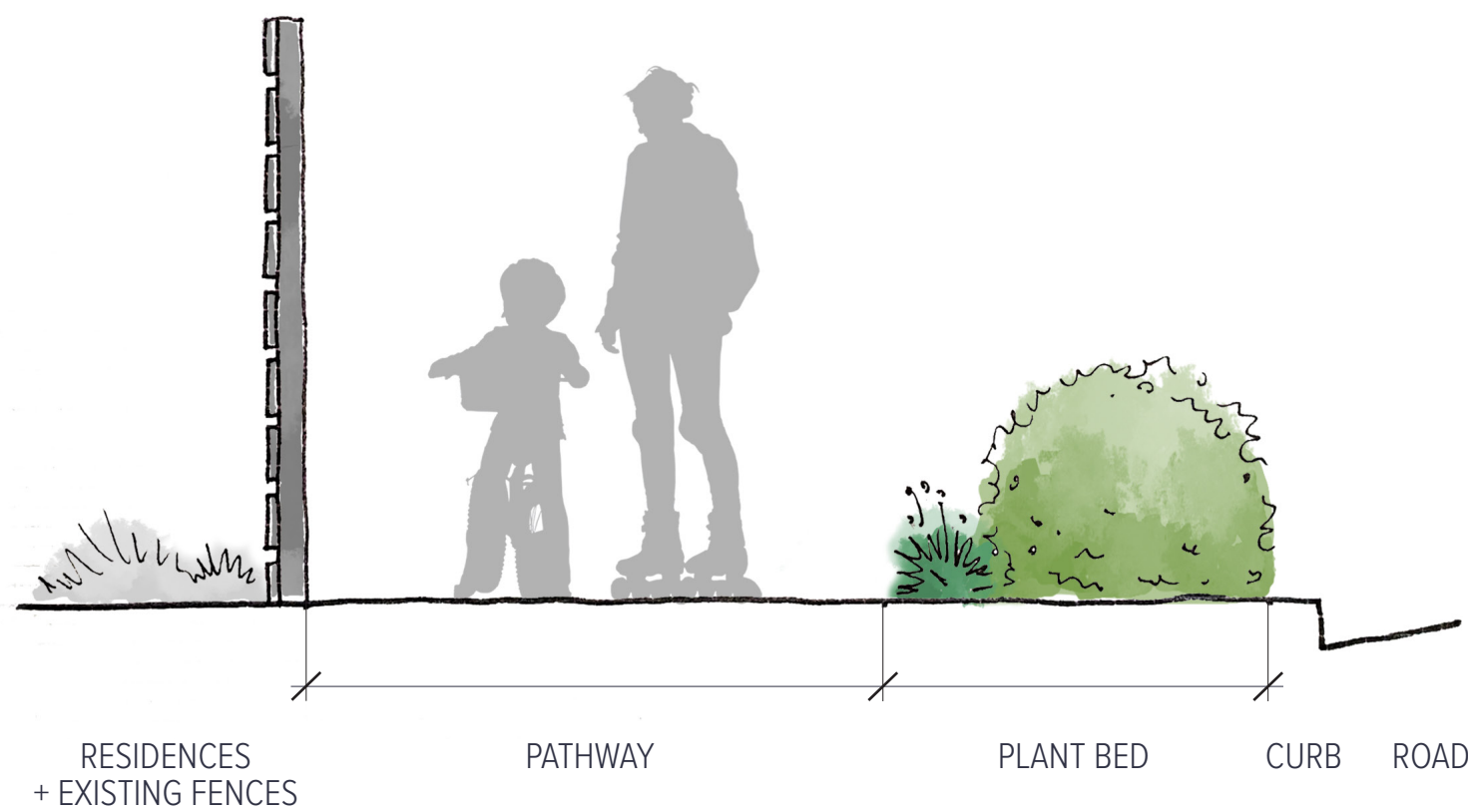

PLAN

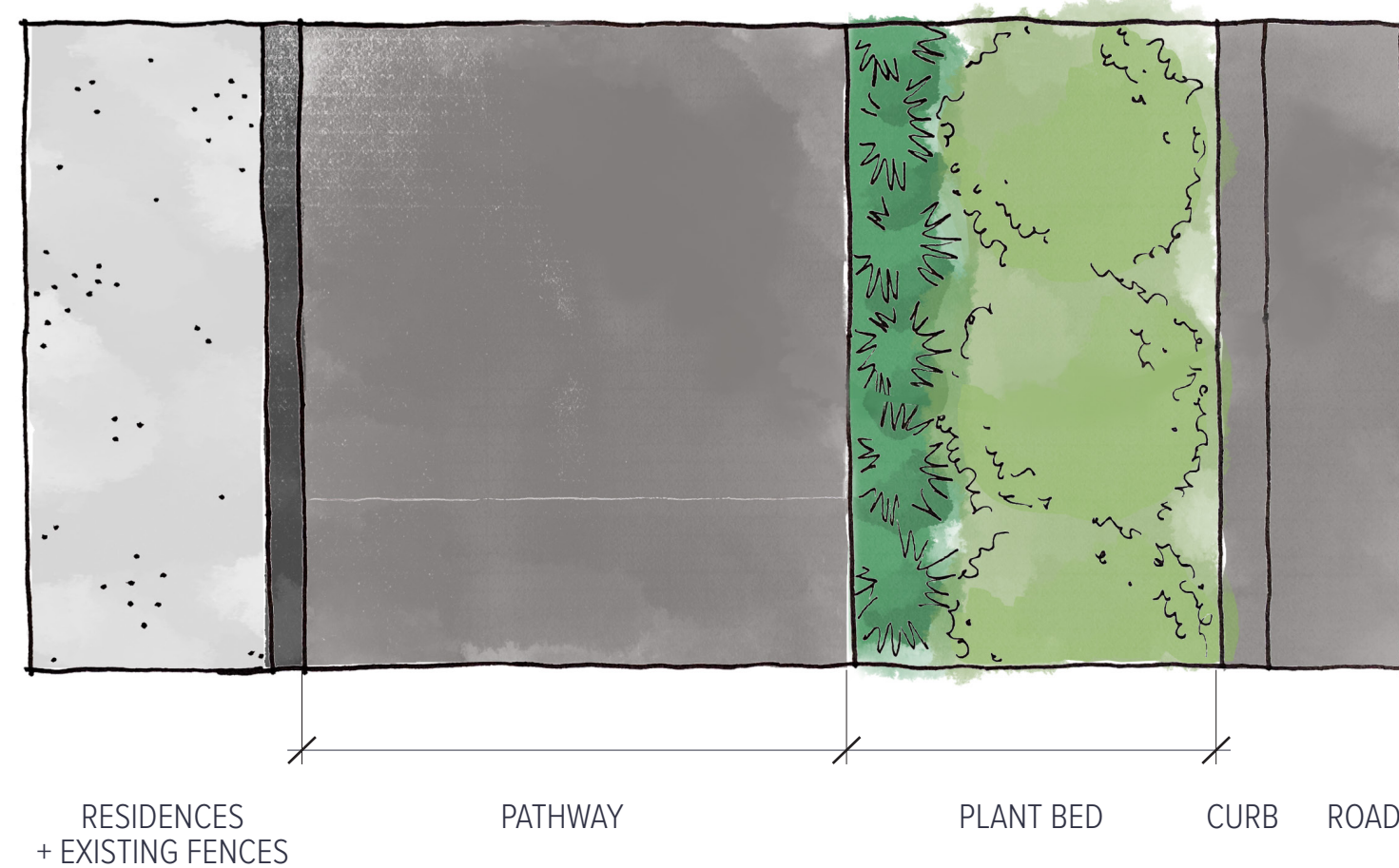

NOTE: EXAMPLE ELEVATION/PLAN SHOWN. ACTUAL LAYOUT TO VARY BY LOCATION. SEE CONCEPT BOARDS FOR FURTHER DETAILS.

Shrub + Groundcover Considerations

for proposed pathway

GOALS

- Maximize privacy for residents
- Enhance neighborhood aesthetics
- Avoid potential pathway obstructions
- Ease of maintenance

IMPLEMENTATION TO MEET GOALS

- Efforts will be made to install mature specimens
- Plants will be low maintenance + drought tolerant
- Plants will be spaced to avoid obstructing path
- For narrow areas, mulch or gravel may be used

NOTE: EXAMPLES SHOWN REPRESENT POTENTIAL PLANTS. SPECIES TO BE DETERMINED IN A LATER DESIGN PHASE.



DEERGRASS (MUHLENBERGIA RIGENS) IS A FINELY TEXTURED CLUMPING GRASS WHICH HOLDS FLOWER STALKS THROUGH FALL



MANZANITA (ARCTOSTAPHYLOS) HAS WINTER FLOWERS + BERRY-SIZE FRUIT



CALIFORNIA LILAC (CEANOTHUS G. HORIZONTALIS) IS EXCELLENT FOR ECOSYSTEM + POLLINATORS



CALIFORNIA GRAY RUSH (JUNCUS PATENS) TOLERATES DROUGHT AND FLOOD, HOLDING ITS RIGID ARCHITECTURAL STRUCTURE