

NO PART OF THIS DOCUMENT MAY BE REPRODUCED IN ANY FORM INCLUDING PHOTOCOPY, RECORDING OR ANY INFORMATION RETRIEVABLE AND STORAGE SYSTEM, WITHOUT PERMISSION IN WRITING FROM SANDIS.

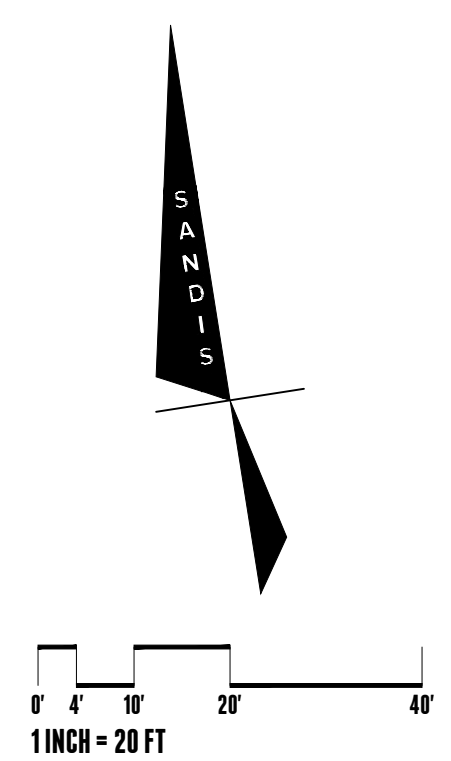
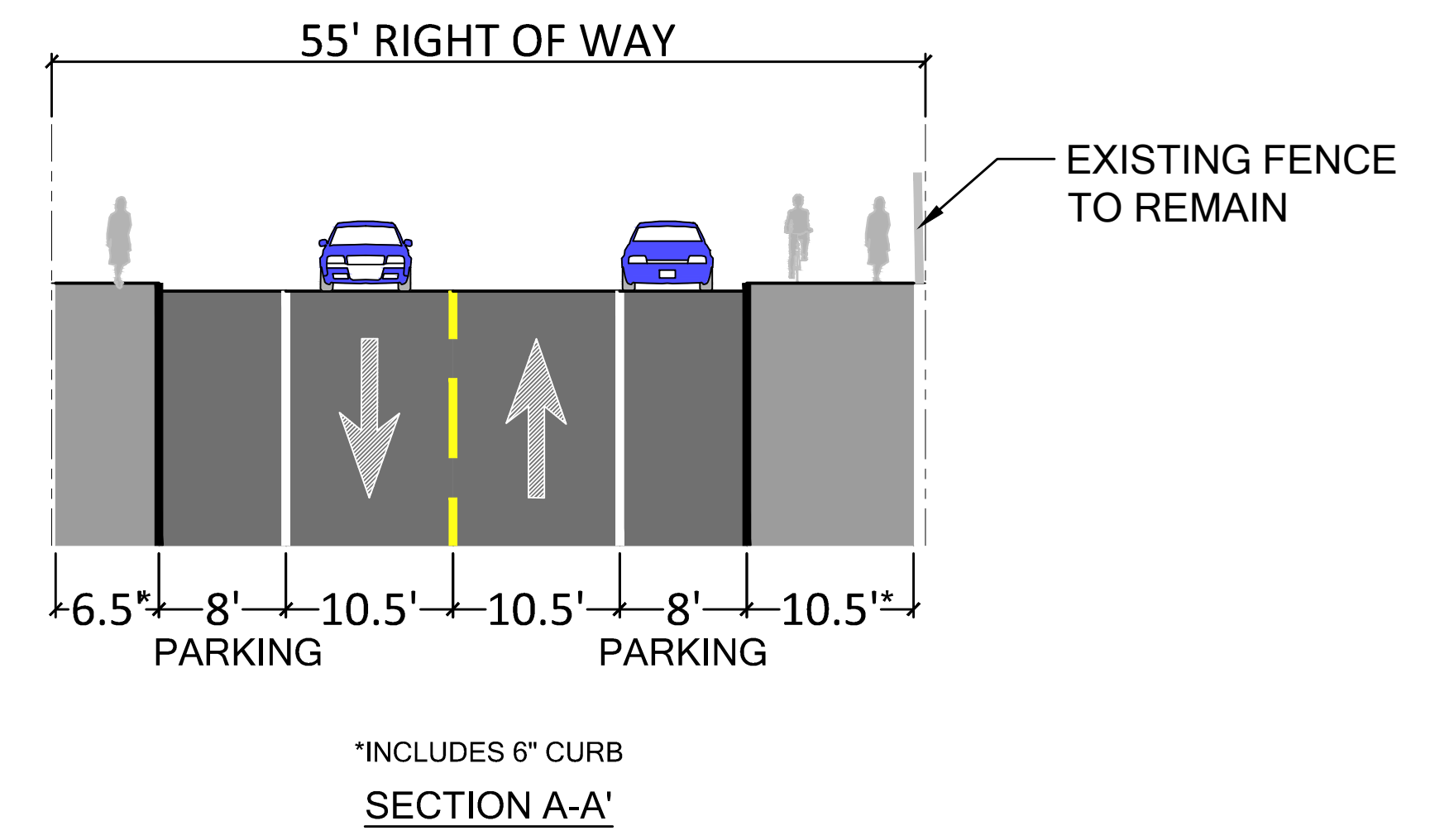
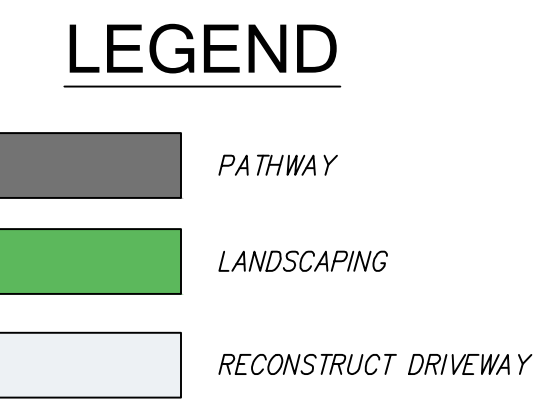
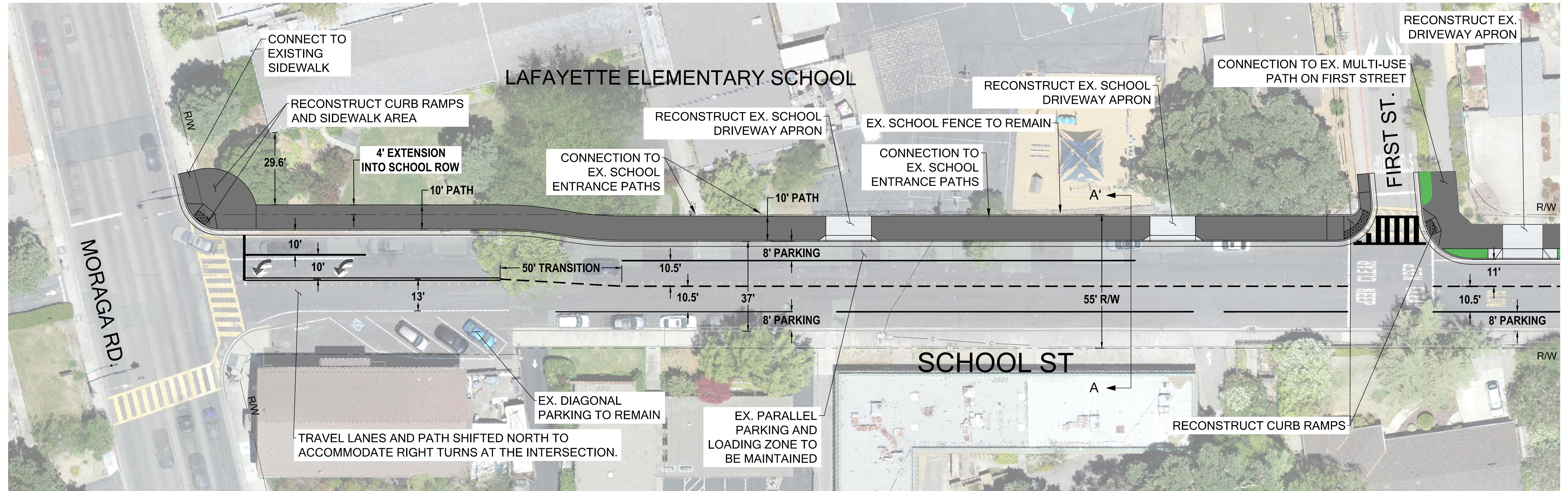

**BUILD ON.**  
SANDIS.NET

DATE: 2024-04-24  
SCALE: 1" = 20'  
PROJECT No.:  
**623048**

No.	REVISION	DATE	BY

**MULTI-USE PATH AND SCHOOLS  
SAFETY PROJECT**  
LAFAYETTE CALIFORNIA

LAYOUT EXHIBIT  
SCHOOL STREET  
PREFERRED ALTERNATIVE

NO PART OF THIS DOCUMENT MAY BE REPRODUCED IN ANY FORM INCLUDING PHOTOCOPY, RECORDING OR ANY INFORMATION RETRIEVABLE AND STORAGE SYSTEM, WITHOUT PERMISSION IN WRITING FROM SANDIS.

MATCHLINE - SEE PREVIOUS SHEET

MATCHLINE - SEE ABOVE RIGHT

MATCHLINE - SEE BELOW LEFT

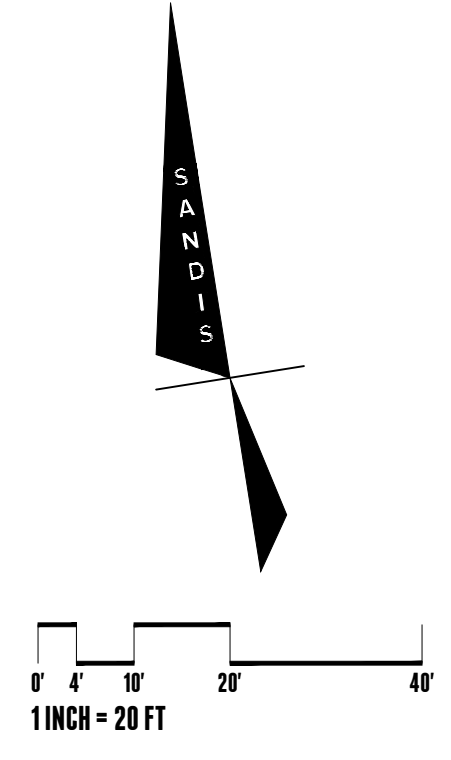
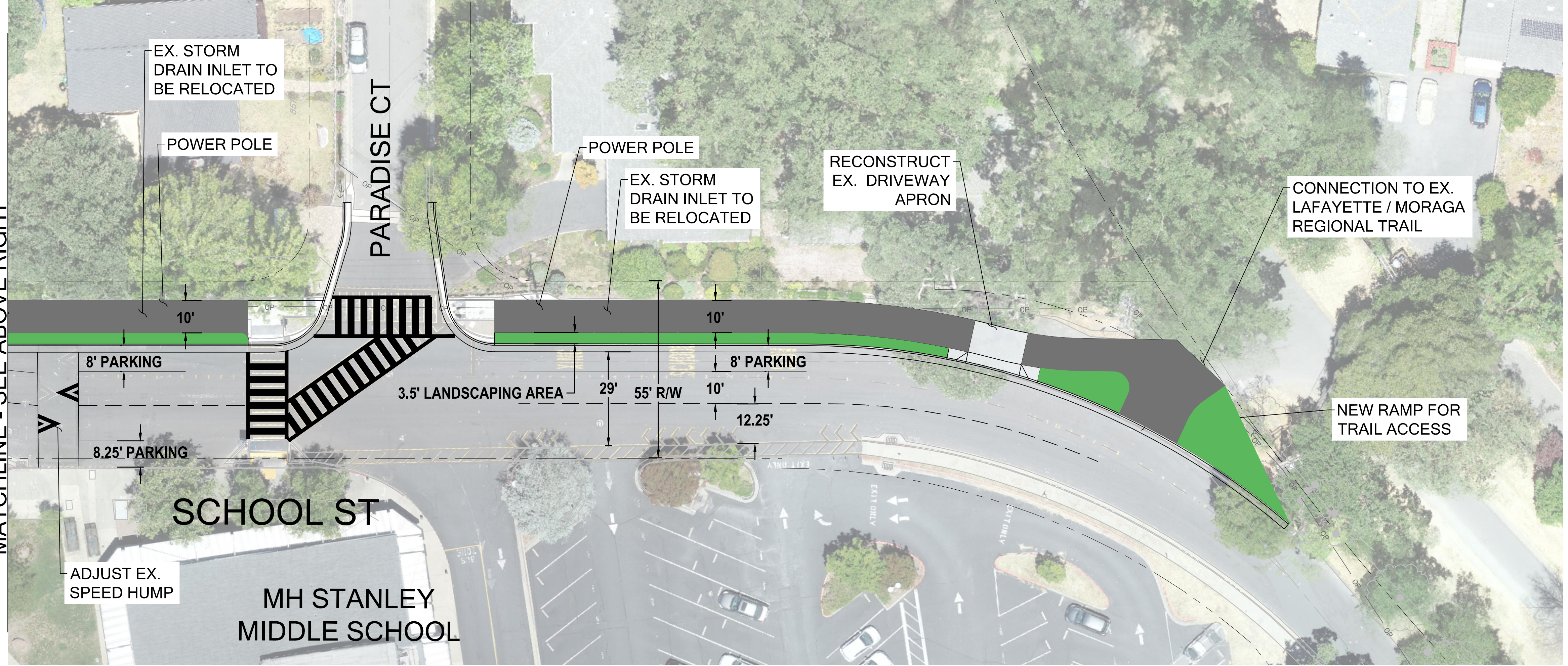
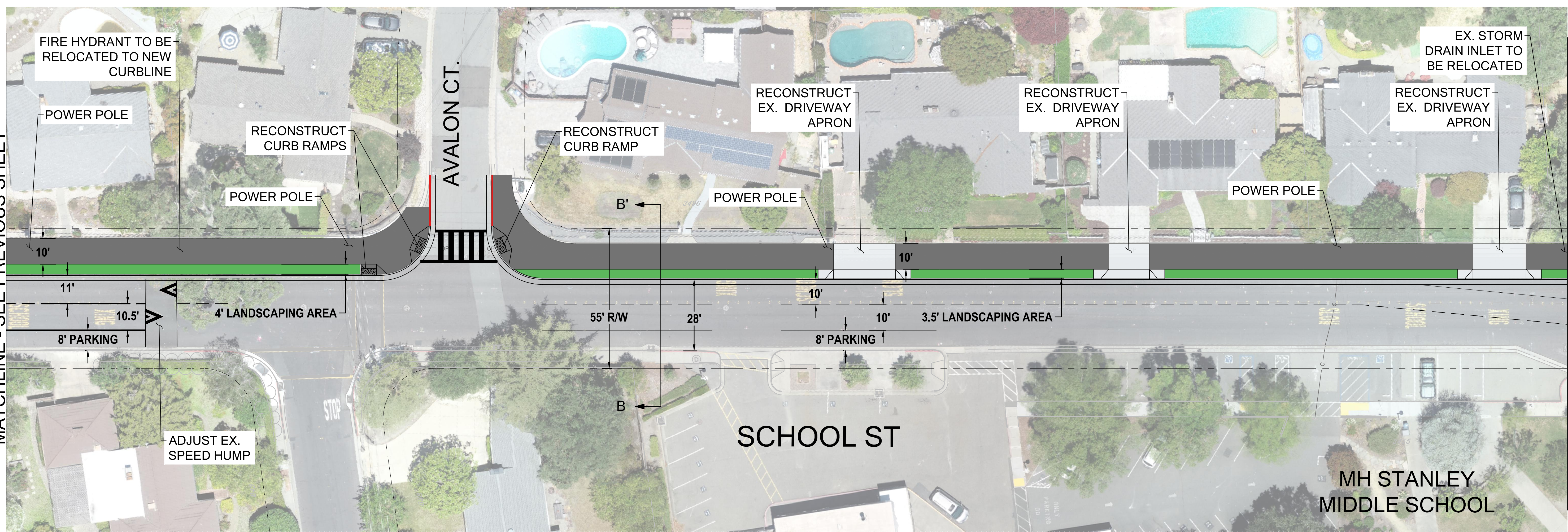

**LEGEND**

- PATHWAY
- LANDSCAPING
- RECONSTRUCT DRIVEWAY

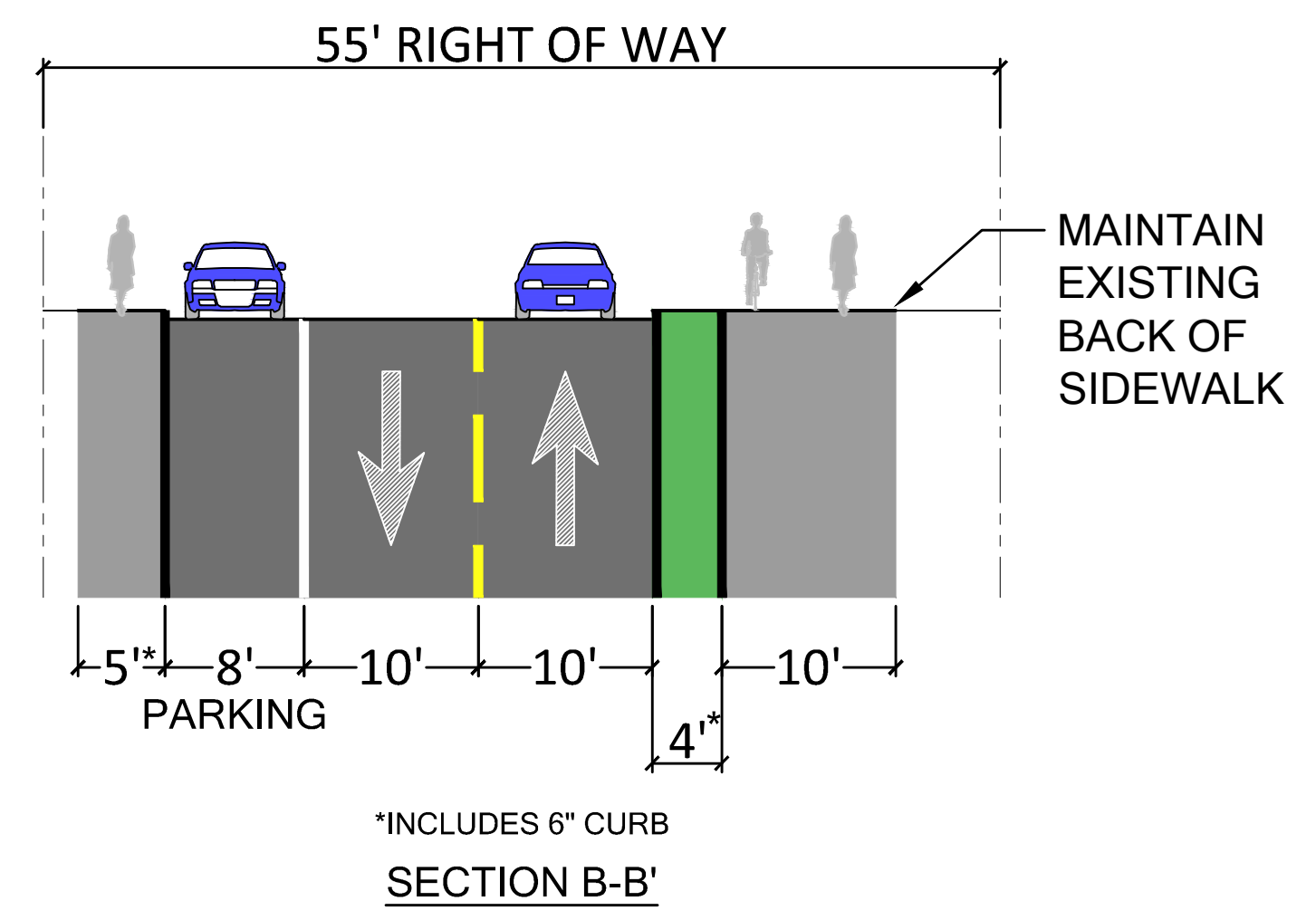

**BUILD ON.**  
SANDIS.NET

DATE: 2024-04-24  
SCALE: 1" = 20'  
PROJECT No.: 623048

No.	REVISION	DATE	BY

**MULTI-USE PATH AND SCHOOLS SAFETY PROJECT**

LAFAYETTE CALIFORNIA

LAYOUT EXHIBIT  
SCHOOL STREET