

# CITY OF LAFAYETTE

## MOUNT DIABLO BOULEVARD WEST END PAVEMENT PRESERVATION PROJECT PROJECT NUMBER 014-9699 FEDERAL AID NUMBER STPL 5404(25)

### GENERAL NOTES:

1. THE CONTRACTOR SHALL NOTIFY THE APPROPRIATE AGENCIES PRIOR TO THE START OF ANY WORK WHICH MAY AFFECT THEIR FACILITIES. THE FOLLOWING UTILITIES AND AGENCIES ARE KNOWN TO HAVE FACILITIES WITHIN THE PROJECT LIMITS:
 

2. CENTRAL CONTRA COSTA SANITARY DISTRICT	(925)228-9500
EAST BAY MUNICIPAL UTILITY DISTRICT (WATER)	(510)287-0834
AT&T (TELEPHONE)	(925)542-9000
PACIFIC GAS AND ELECTRIC (GAS)	(510)784-3211
PACIFIC GAS AND ELECTRIC (ELECTRIC)	(510)784-3236
CONSOLIDATED FIRE PROTECTION DISTRICT	(925)930-5531
COMCAST (CABLE TELEVISION)	(925)349-3300
SPRINT	(650)513-2545
3. THE CONTRACTOR SHALL INSPECT THE PROJECT SITE PRIOR TO SUBMITTING A BID IN ORDER TO OBSERVE AND DETERMINE THE EXISTING SITE CONDITIONS.
4. TRAFFIC CONTROL DURING CONSTRUCTION SHALL BE THE CONTRACTOR'S RESPONSIBILITY. ALL TRAFFIC CONTROL AND DEVICES SHALL BE IN ACCORDANCE WITH THE LATEST EDITION OF THE "MANUAL OF TRAFFIC CONTROLS FOR CONSTRUCTION AND MAINTANCE WORK ZONES" USED BY THE STATE OF CALIFORNIA, DEPARTMENT OF TRANSPORTATION.
5. THE CONTRACTOR SHALL ASSUME SOLE AND COMPLETE RESPONSIBILITY FOR JOB SITE CONDITIONS DURING THE COURSE OF CONSTRUCTION OF THE PROJECT. THESE PLANS DO NOT INCLUDE COMPONENTS NECESSARY FOR CONSTRUCTION SAFETY. IT IS THE CONTRACTOR'S RESPONSIBILITY TO PROVIDE FOR THE SAFETY OF ALL PERSONS AND PROPERTY DURING THE COURSE OF THE PROJECT.
6. THE CONTRACTOR SHALL COMPLY WITH THE RULES AND REGULATIONS OF CAL/OSHA. THIS REQUIREMENT SHALL BE MADE TO APPLY CONTINUOUSLY AND NOT BE LIMITED TO NORMAL WORKING HOURS.
7. THE CONTRACTOR SHALL PROVIDE FOR CONTINUOUS INGRESS AND EGRESS TO ALL PUBLIC AND PRIVATE PROPERTIES ADJACENT TO THE WORK THROUGHOUT THE PERIOD OF CONSTRUCTION.
8. THE CONTRACTOR SHALL BE RESPONSIBLE FOR ANY DAMAGE TO THE SITE OR THE SURROUNDING AREA AS A RESULT OF THE CONTRACTOR'S WORK OR OPERATIONS. EXISTING CURB, GUTTER, SIDEWALK, DRIVEWAY AND ANY OTHER IMPROVEMENTS THAT ARE DAMAGED OR DISPLACED BY THE CONTRACTOR SHALL BE REPLACED AT THE CONTRACTOR'S EXPENSE.
9. THE CONTRACTOR SHALL LOCATE, REFERENCE, AND SET SUFFICIENT MARKS FOR ALL CITY OWNED AND NON-CITY OWNED EXISTING MANHOLE COVERS, VALVE COVERS, SURVEY MONUMENTS, IRON PIPES, RAILROAD SPIKES, PRIOR TO STARTING ANY WORK IN THE PAVING AREA WITHIN THE PROJECT LIMITS.
10. THE LOCATION OF CURB, GUTTER, SIDEWALK AND DRIVEWAY REMOVAL AND CONSTRUCTION SHALL BE MARKED IN THE FIELD BY THE ENGINEER PRIOR TO THE START OF WORK.
11. PAVEMENT REPAIR AREAS SHALL BE MARKED IN THE FIELD BY ENGINEER PRIOR TO THE START OF REPAIR WORK.

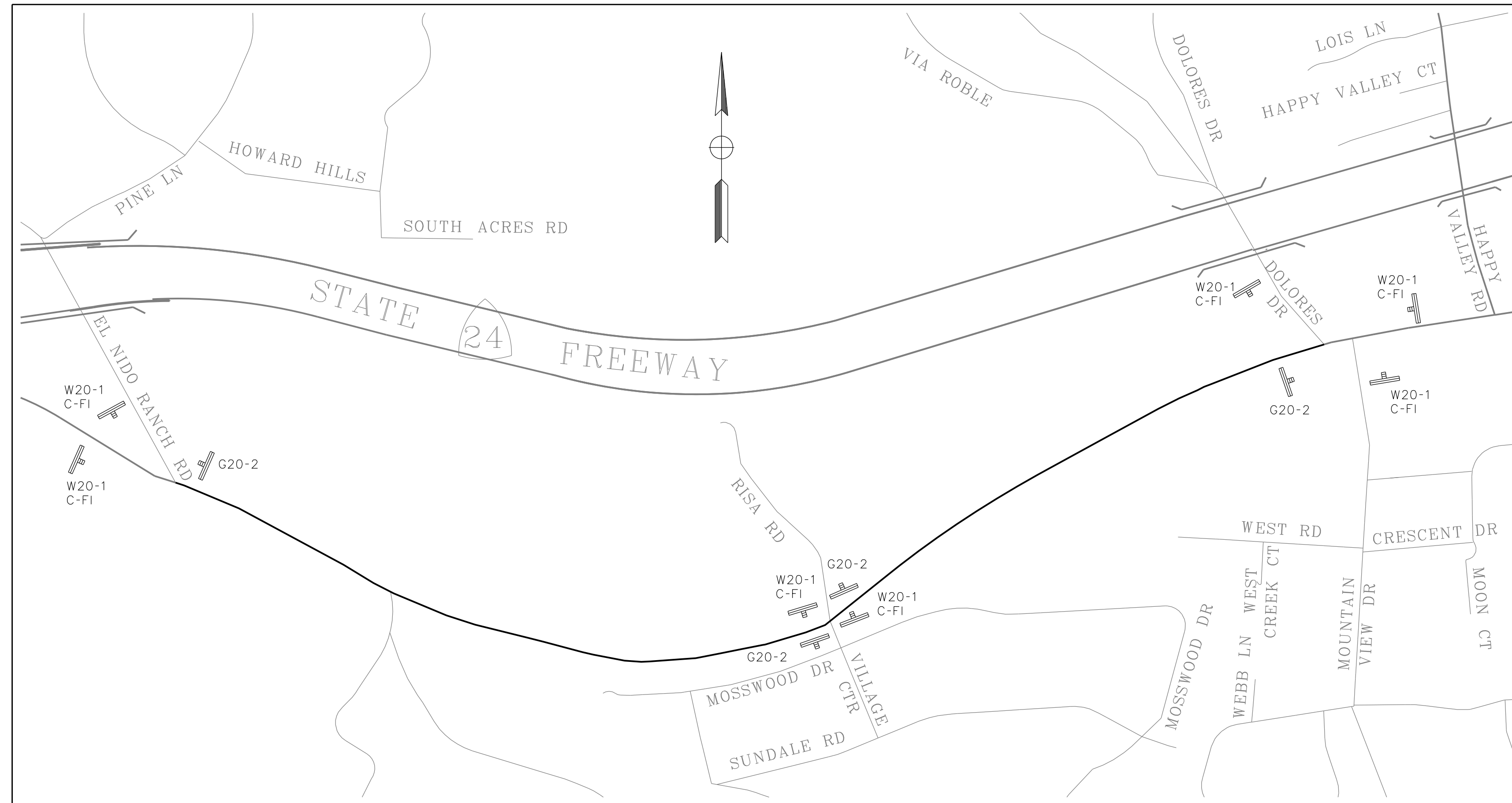

VICINITY MAP  
NTS

### SHEET INDEX:

NO.	DESCRIPTION
1	TITLE SHEET AND LOCATION MAP
2	CONSTRUCTION DETAILS
3-5	PLAN SHEETS

### CONSTRUCTION AREA SIGNS:

SYMBOL	DESCRIPTION	SIZE	QUANTITY
G 20-2	"END ROAD WORK"	42"X18"	4
W 20-1	"ROAD WORK AHEAD"	36"X36"	7
C-FI	PROJECT IDENTIFICATION AND FUNDING SIGN	48"X36"	7

### APPLICABLE STANDARD PLANS

INCLUDING BUT NOT LIMITED TO THE FOLLOWING:

CALTRANS STANDARD PLANS (DATED JULY 2002)	
A20	A,B,C,D PAVEMENT MARKERS AND TRAFFIC LINES, TYPICAL DETAILS
A24	A,B,C,D PAVEMENT MARKINGS, ARROWS, SYMBOLS, NUMERALS, WORDS AND CROSSWALKS
A87 B	ASPHALT CONCRETE DIKES
A88A	CURB RAMP DETAILS
A88B	CURB RAMP AND ISLAND PASSAGEWAY DETAILS

DATE	MARK	REVISION	INIT.

Designed by:	JML
Drawn by:	JML
Checked by:	TC
Reviewed by:	TC
Date:	1-17-14

SIGN: DATE: 1-17-14

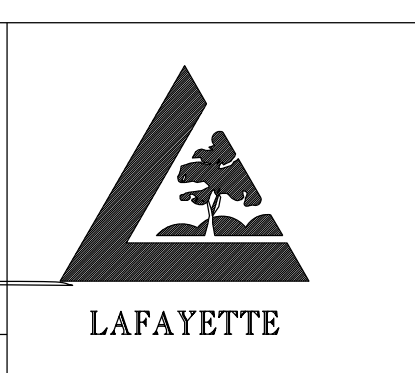

3675 Mount Diablo Boulevard, Suite 210  
Lafayette, California, 94549-1968  
(925) 299-3217 Fax (925)284-3169  
www.ci.lafayette.ca.us

REVIEWED BY:  
CITY OF LAFAYETTE  
  
Tony Coe, Engineering Services Manager Date: 1-17-14

CITY OF LAFAYETTE  
PROJECT NO. 014-9699  
MOUNT DIABLO BOULEVARD WEST END  
PAVEMENT PRESERVATION PROJECT  
CONTRA COSTA COUNTY CALIFORNIA

TITLE SHEET AND  
CONSTRUCTION AREA SIGNS  
SCALE: NTS SHEET 1 of 5

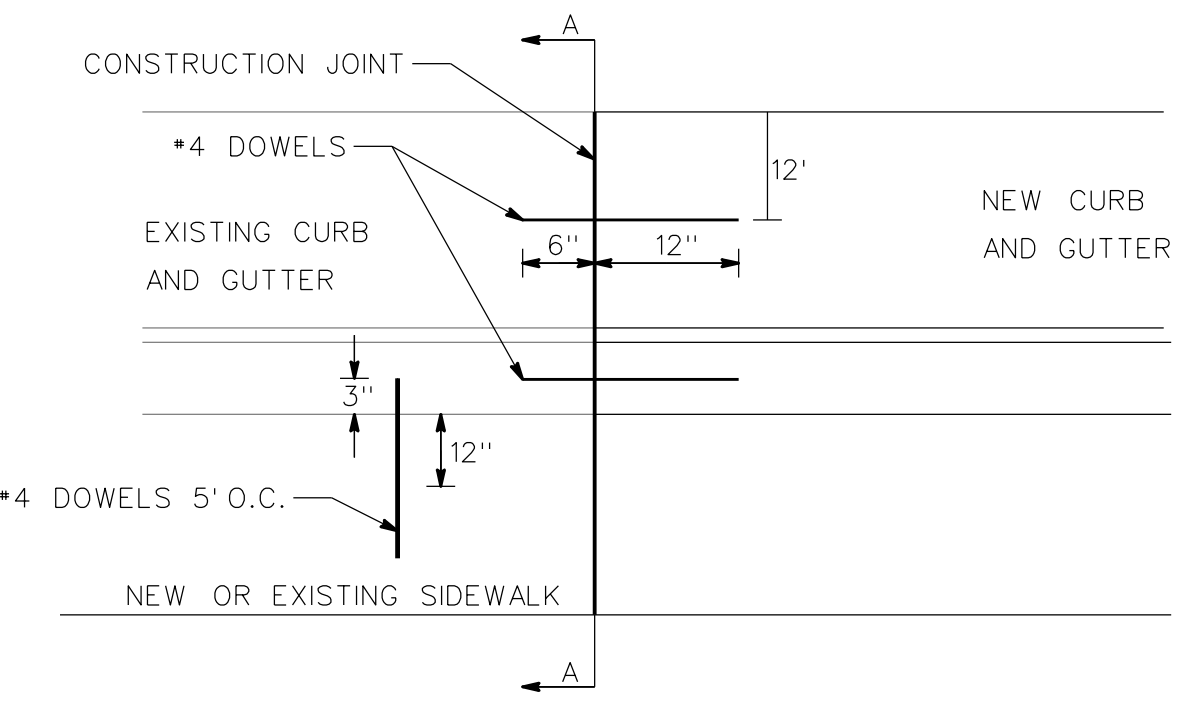

1  
2  
REPLACEMENT CURB AND GUTTER DETAIL  
NTS

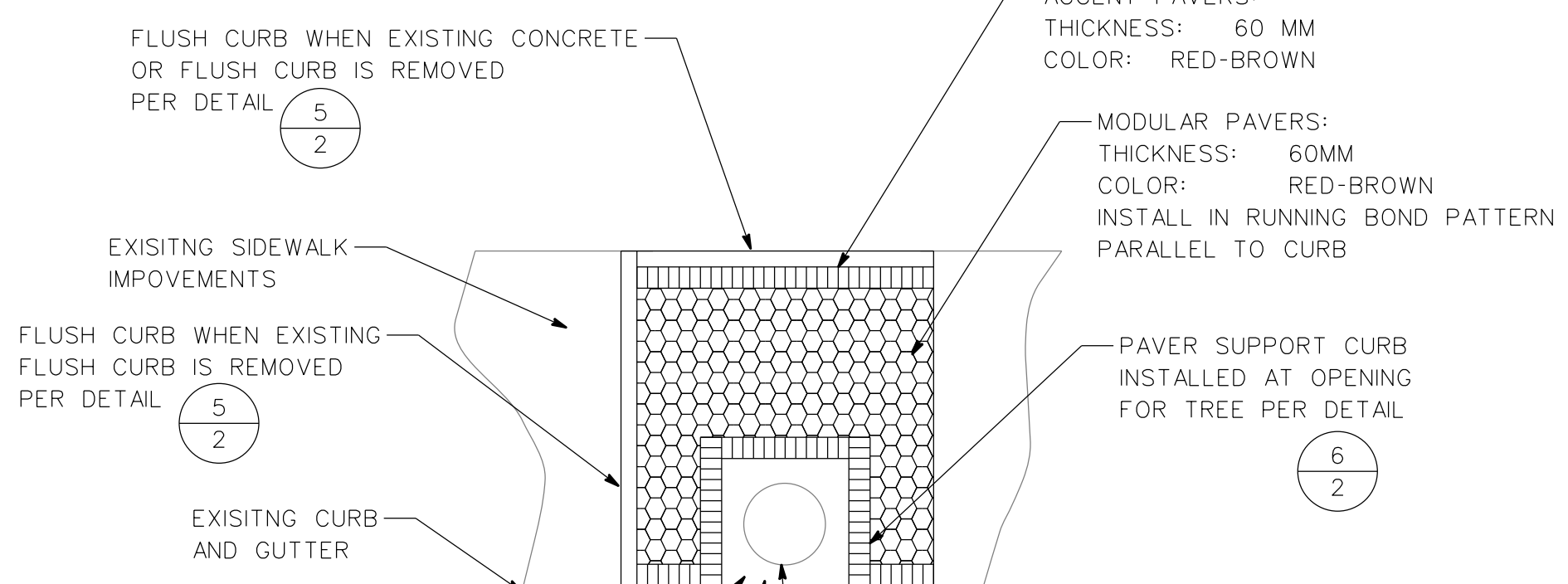
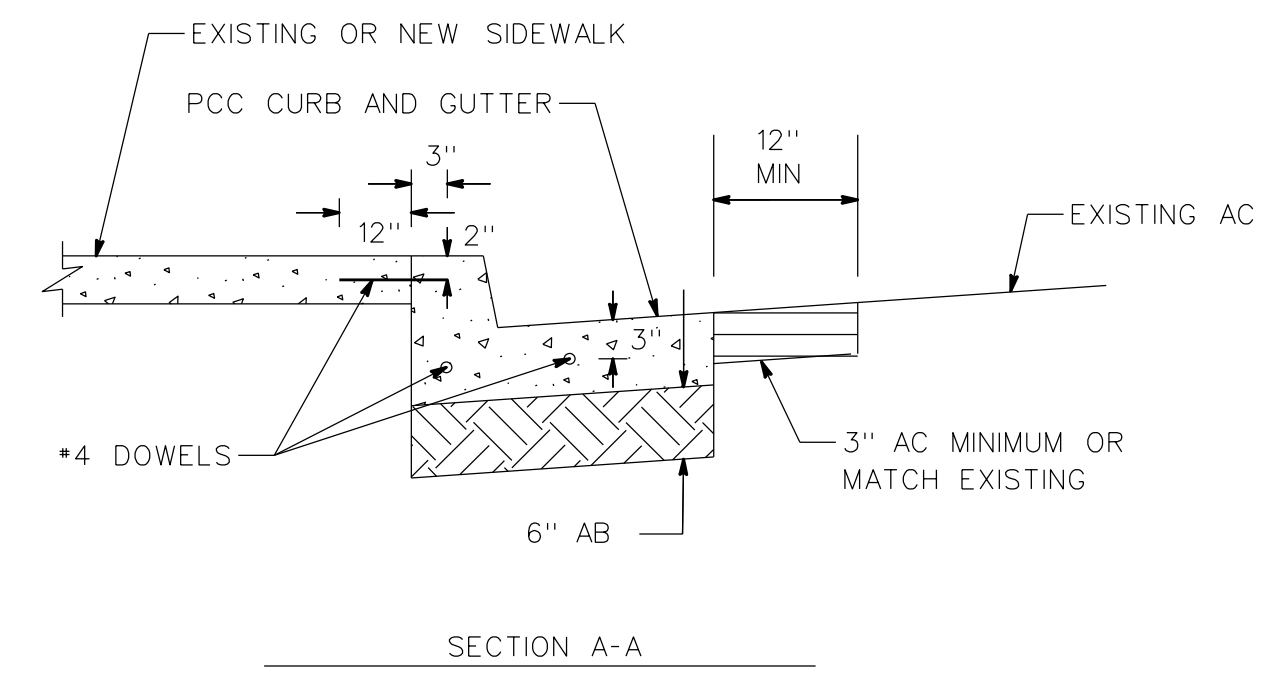

4  
2  
TREE WELL WITH DECORATIVE PAVERS DETAIL  
NTS

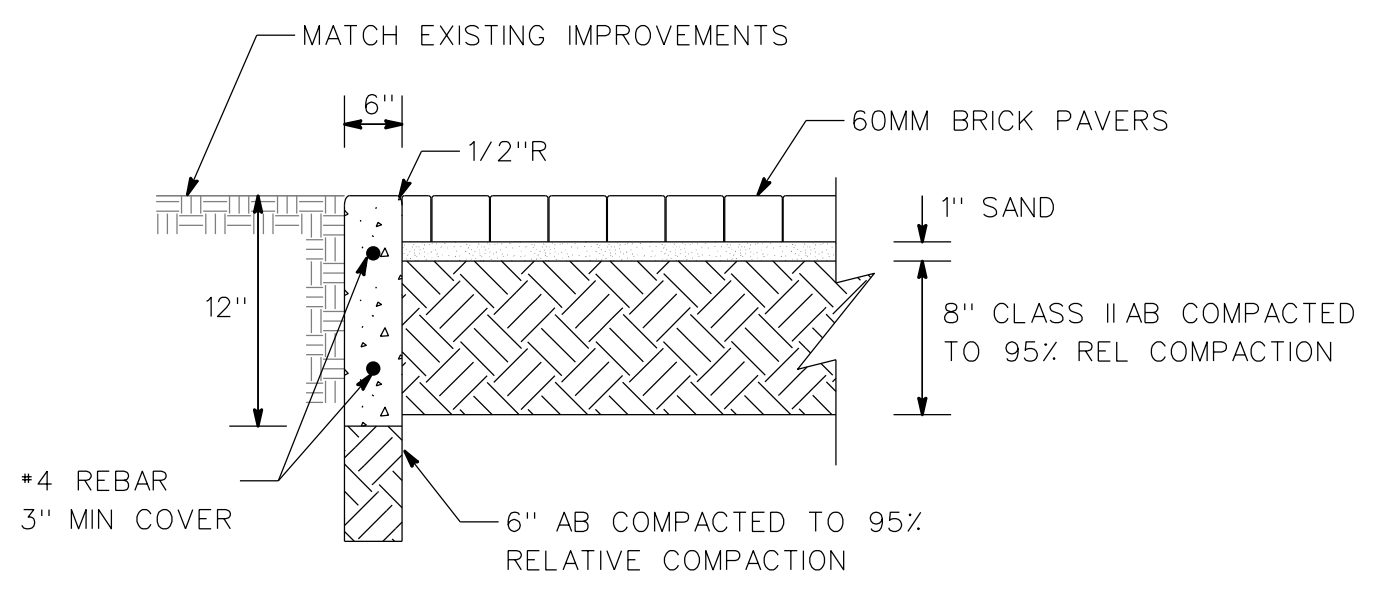

5  
2  
FLUSH CURB AND TYPICAL PAVER DETAIL  
NTS

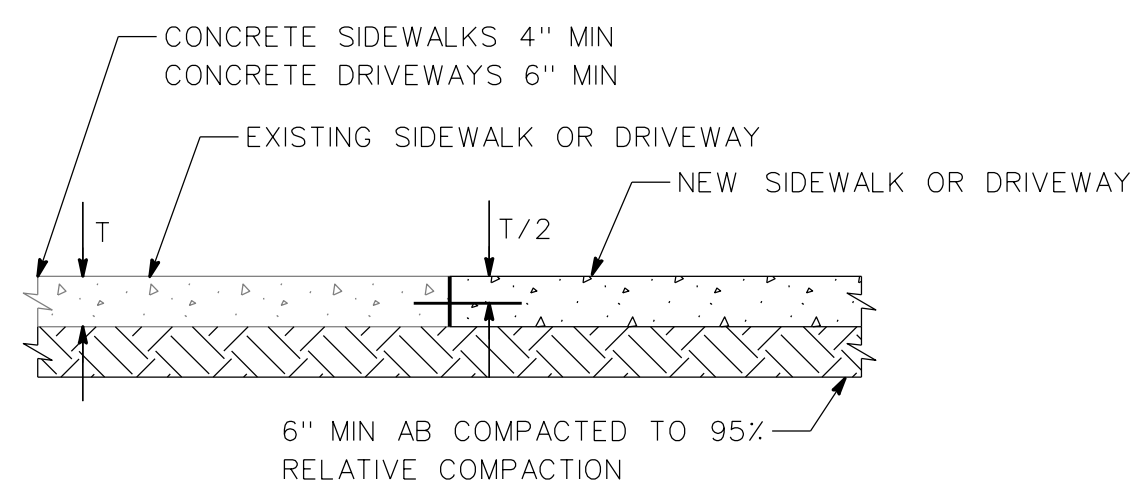
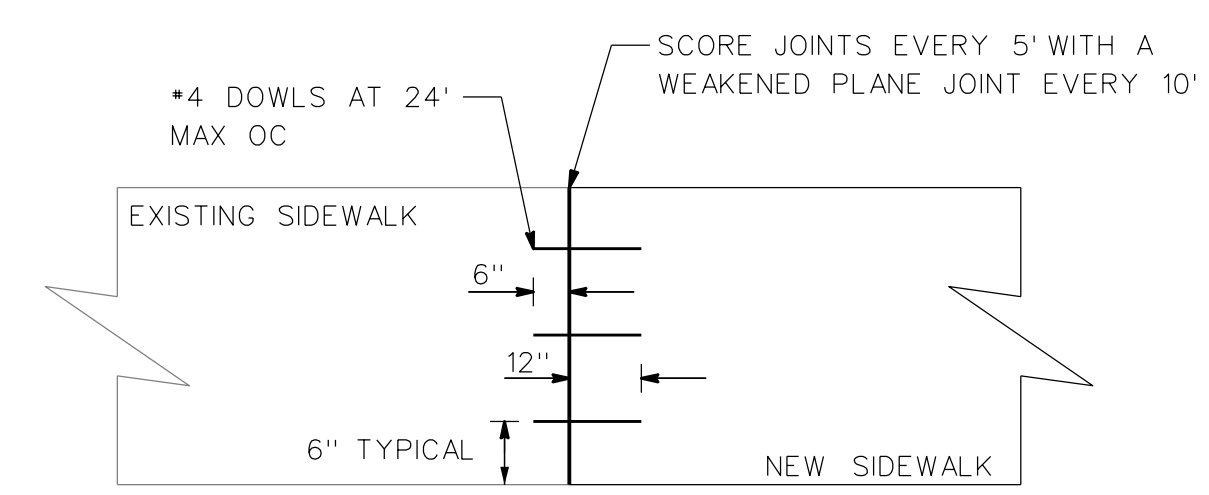

2  
2  
REPLACEMENT SIDEWALK DETAIL  
NTS

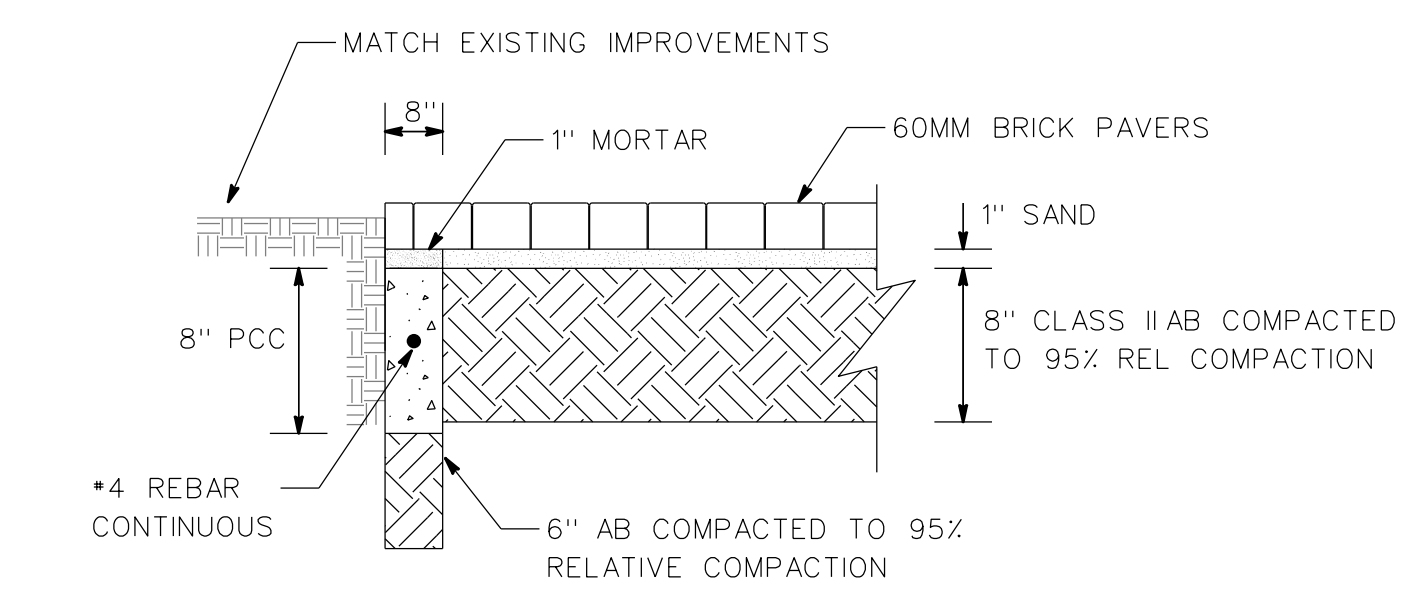

6  
2  
PAVER SUPPORT CURB AND TYPICAL PAVER DETAIL  
NTS

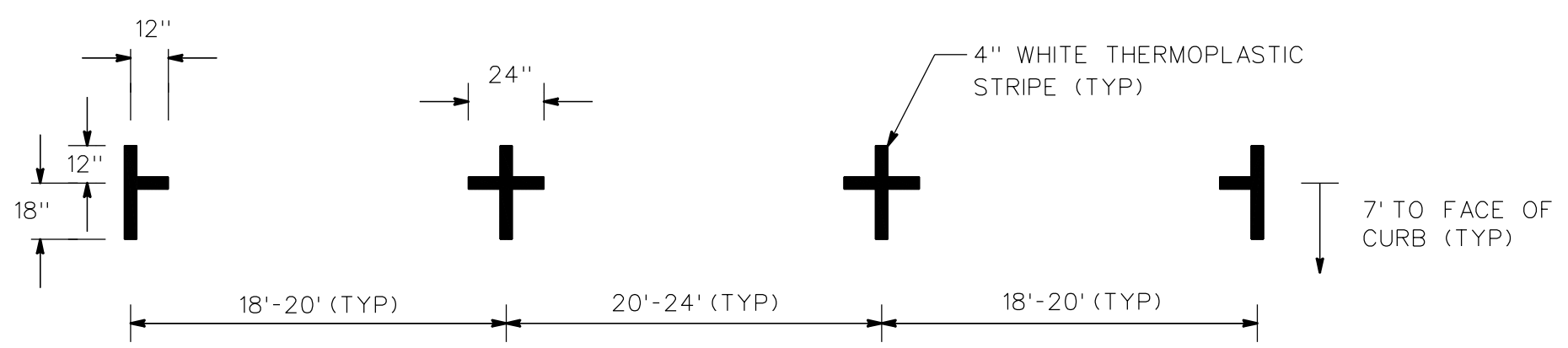

3  
2  
TYPICAL PARKING STALL STRIPING DETAIL  
NTS

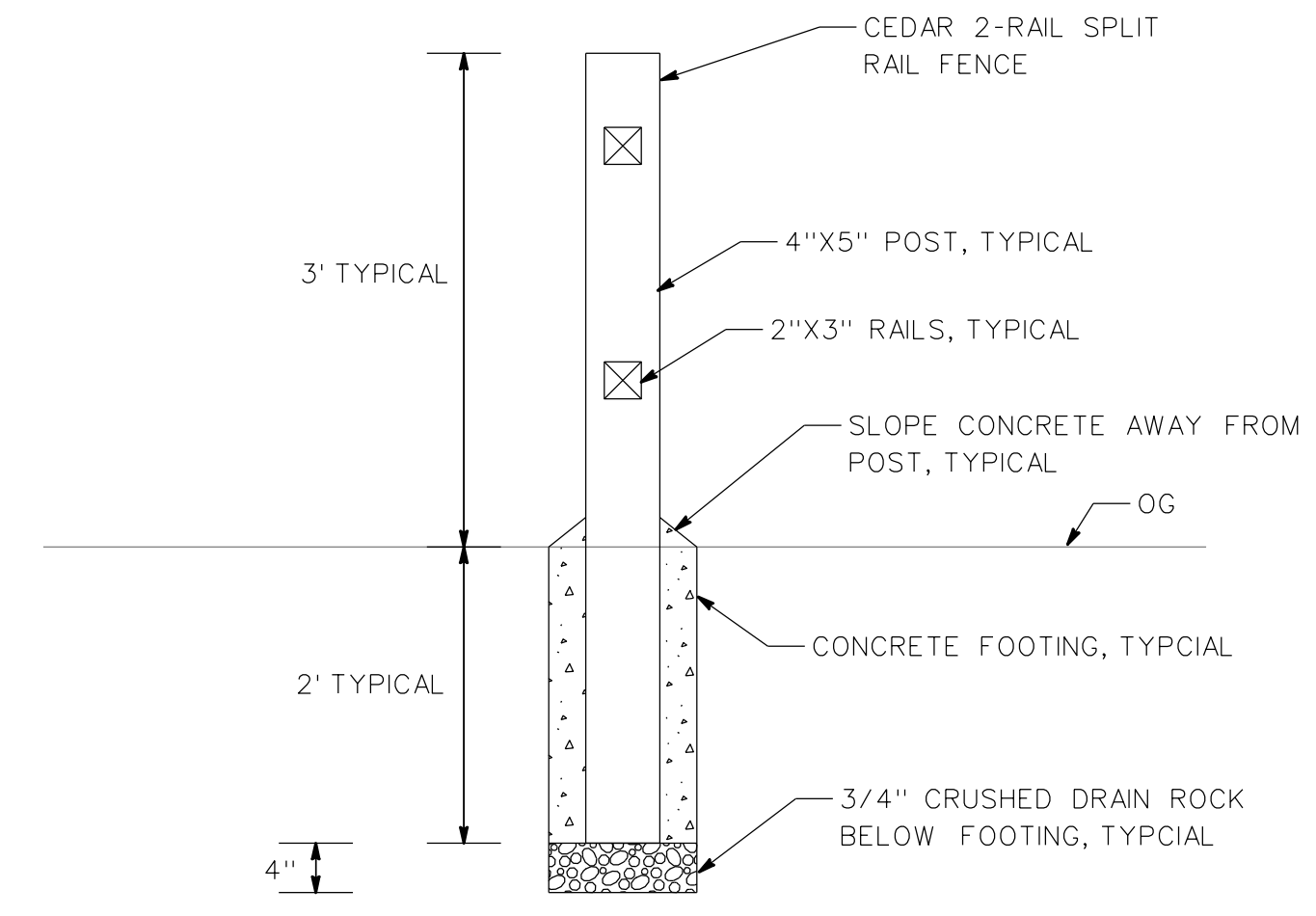

7  
2  
CEDAR SPLIT RAIL FENCE DETAIL  
NTS

DATE	MARK	REVISION	INIT.

Designed by: JML  
 Drawn by: JML  
 Checked by: TC  
 Reviewed by: TC  
 Date: 1-17-14

PROFESSIONAL ENGINEER  
 JOHN W. LUTTROPP  
 No. 55064  
 Exp. 6/30/14  
 CIVIL  
 STATE OF CALIFORNIA  
 SIGN: *[Signature]* DATE: 1-17-14



3675 Mount Diablo Boulevard, Suite 210  
 Lafayette, California, 94549-1968  
 (925) 299-3217 Fax (925) 284-3169  
 www.ci.lafayette.ca.us

REVIEWED BY:  
 CITY OF LAFAYETTE  
*[Signature]*  
 Tony Coe, Engineering Services Manager  
 Date: 1-14-14

CITY OF LAFAYETTE  
 PROJECT NO. 014-9699  
 MOUNT DIABLO BOULEVARD WEST END  
 PAVEMENT PRESERVATION PROJECT  
 CONTRA COSTA COUNTY CALIFORNIA

CONSTRUCTION DETAILS  
 SCALE: NTS  
 SHEET 2 of 5



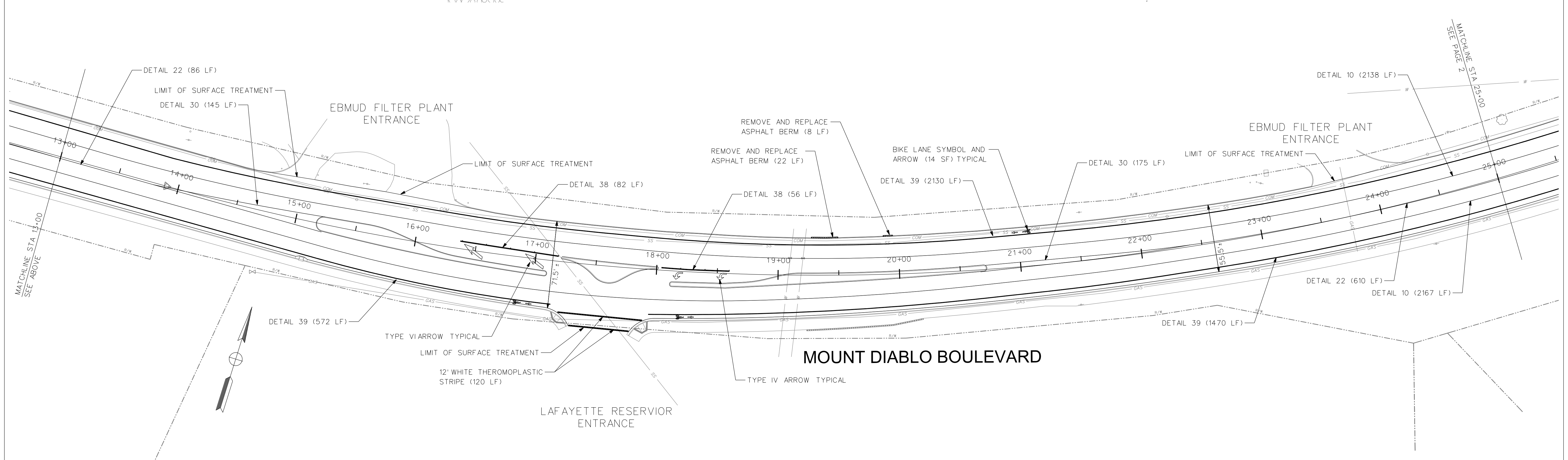
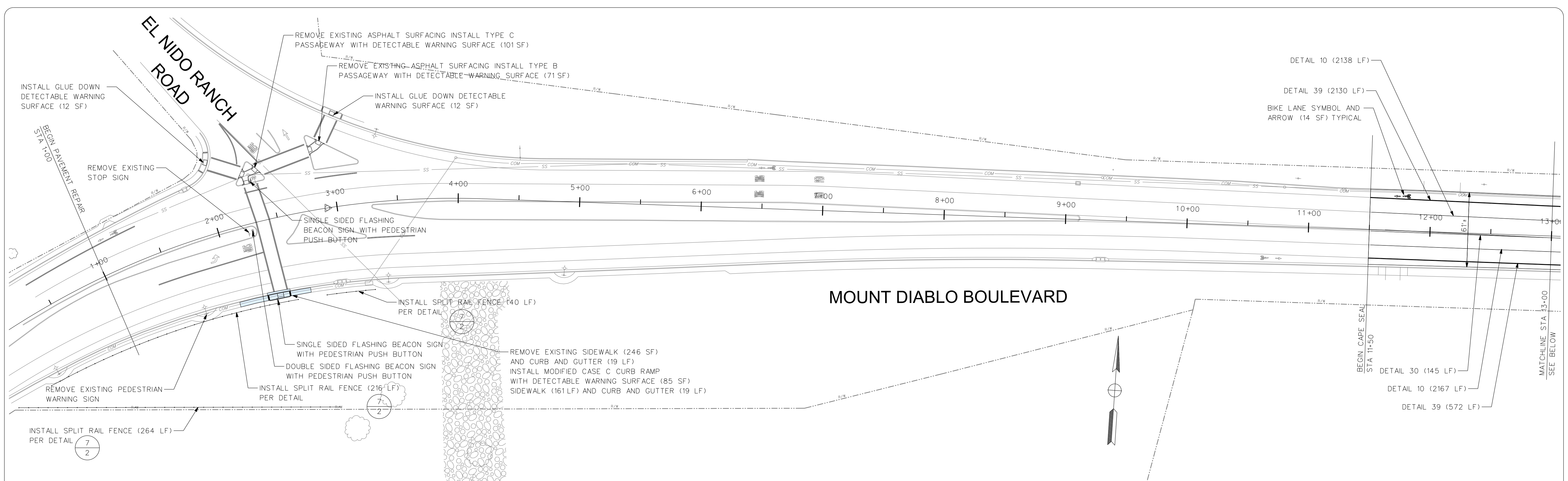

DATE	MARK	REVISION	INIT.

Designed by: JML  
 Drawn by: JML  
 Checked by: TC  
 Reviewed by: TC  
 Date: 1-17-14

JOHN W. LUTTROPP  
 No. 55064  
 Exp. 6/30/14  
 PROFESSIONAL ENGINEER  
 STATE OF CALIFORNIA  
 SIGN: *[Signature]* DATE: 1-17-14



3675 Mount Diablo Boulevard, Suite 210  
 Lafayette, California, 94549-1968  
 (925) 299-3217 Fax (925)284-3169  
 www.ci.lafayette.ca.us

REVIEWED BY:  
 CITY OF LAFAYETTE  
*[Signature]*  
 Tony Coe, Engineering Services Manager Date: 1-17-14

CITY OF LAFAYETTE  
 PROJECT NO. 014-9699  
 MOUNT DIABLO BOULEVARD WEST END  
 PAVEMENT PRESERVATION PROJECT  
 CONTRA COSTA COUNTY CALIFORNIA



PLAN SHEET  
 SCALE: 1"=40'  
 SHEET 3 of 5

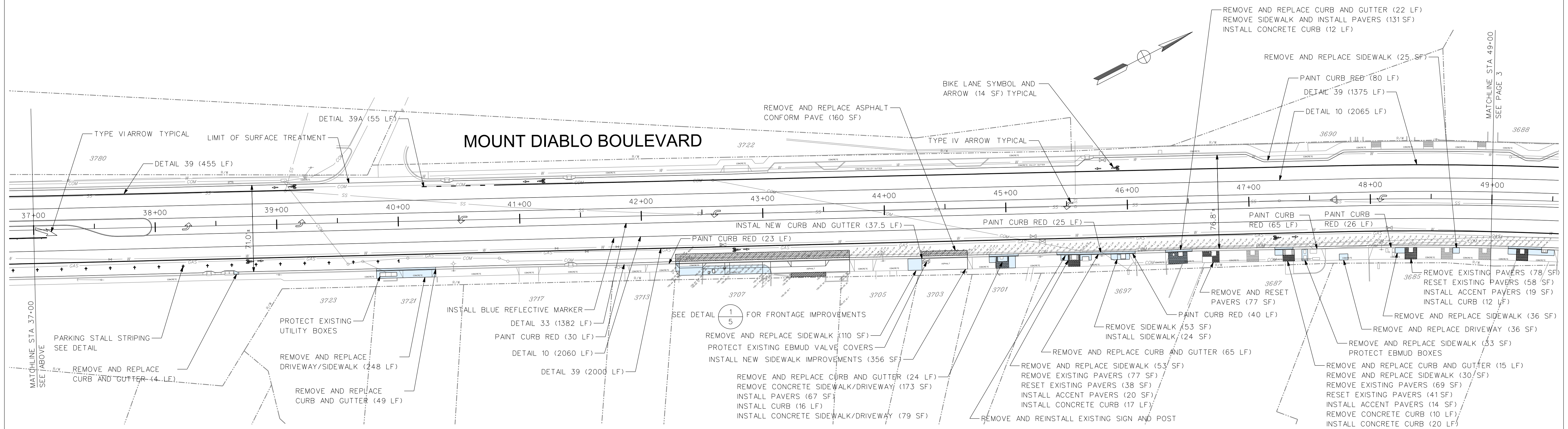
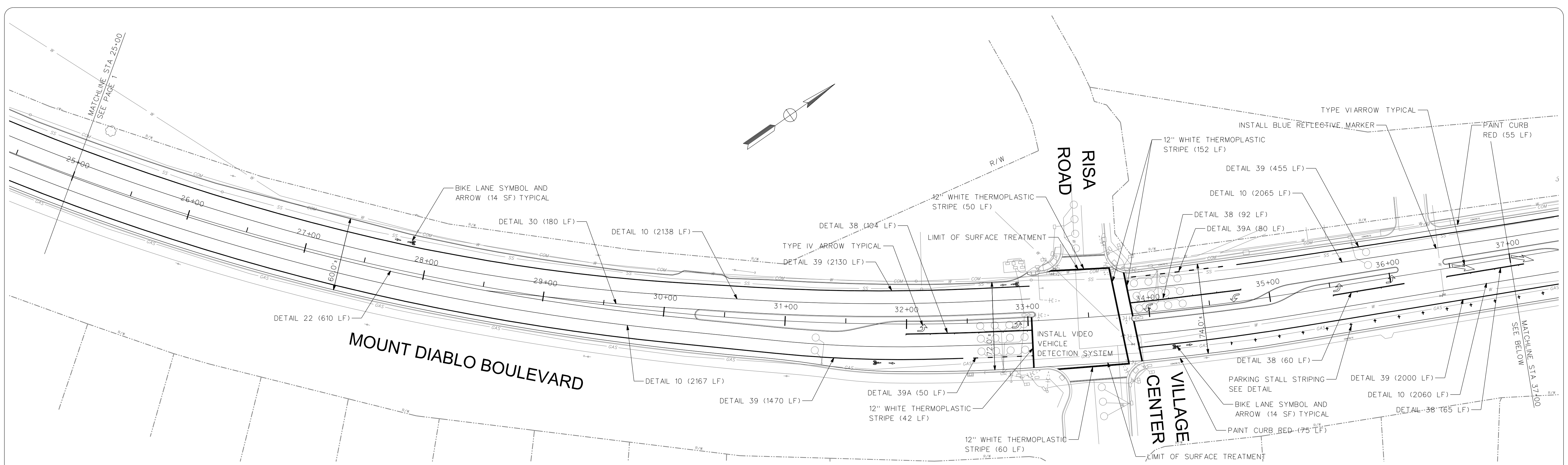



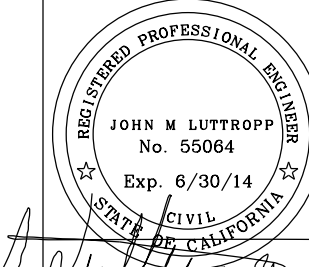

DATE	MARK	REVISION	INIT.

Designed by: JML  
 Drawn by: JML  
 Checked by: TC  
 Reviewed by: TC  
 Date: 1-17-14

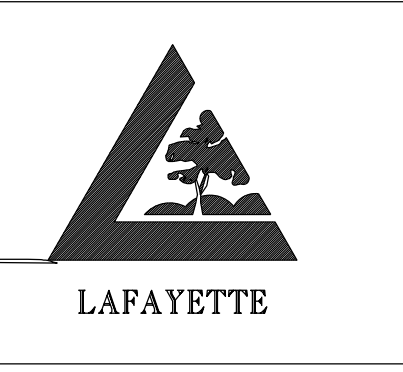
  
 SIGN:  DATE: 1-17-14



3675 Mount Diablo Boulevard, Suite 210  
 Lafayette, California, 94549-1968  
 (925) 299-3217 Fax (925) 284-3169  
 www.ci.lafayette.ca.us

REVIEWED BY:  
 CITY OF LAFAYETTE  
  
 Tony Coe, Engineering Services Manager Date: 1-17-14

CITY OF LAFAYETTE  
 PROJECT NO. 014-9699  
 MOUNT DIABLO BOULEVARD WEST END  
 PAVEMENT PRESERVATION PROJECT  
 CONTRA COSTA COUNTY CALIFORNIA

PLAN SHEET  
 SCALE: 1"=40'  
 SHEET 4 of 5



