

WALL TYPE 1
STONE VENEER
BLENDS WITH CREEK

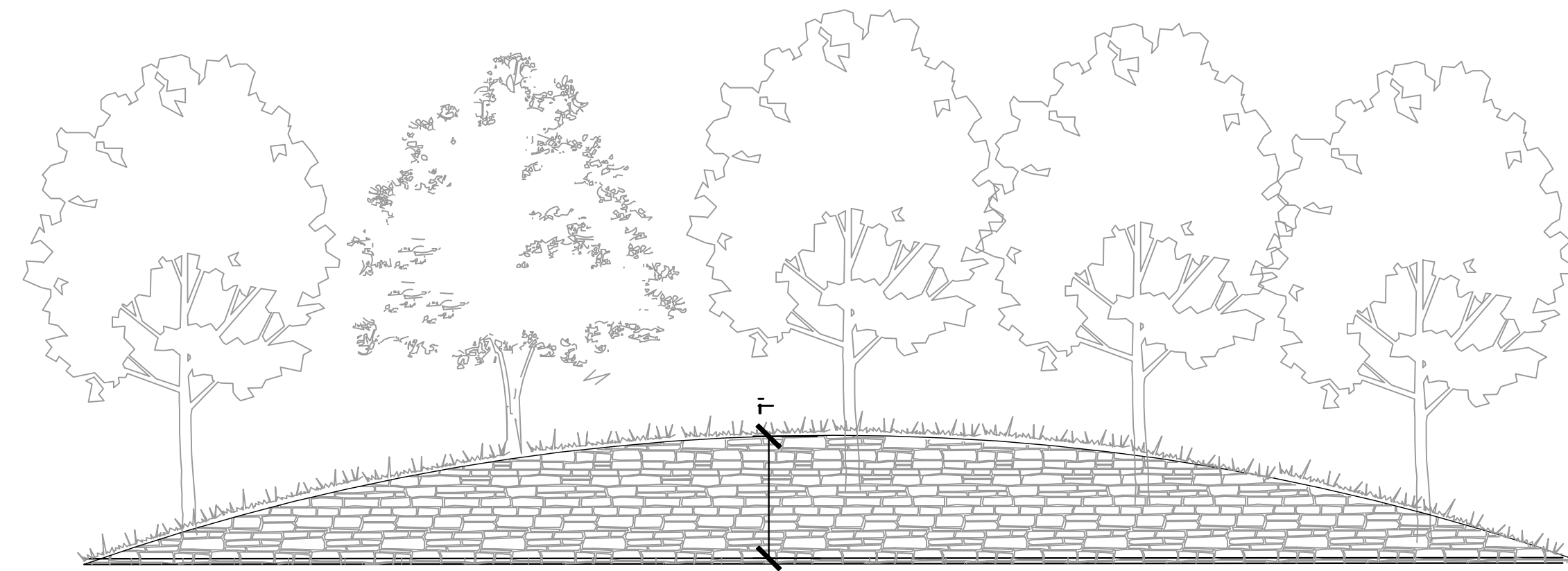

WALL 2
STONE VENEER- 1' MAX
ADJACENT TO INTERIOR ROAD

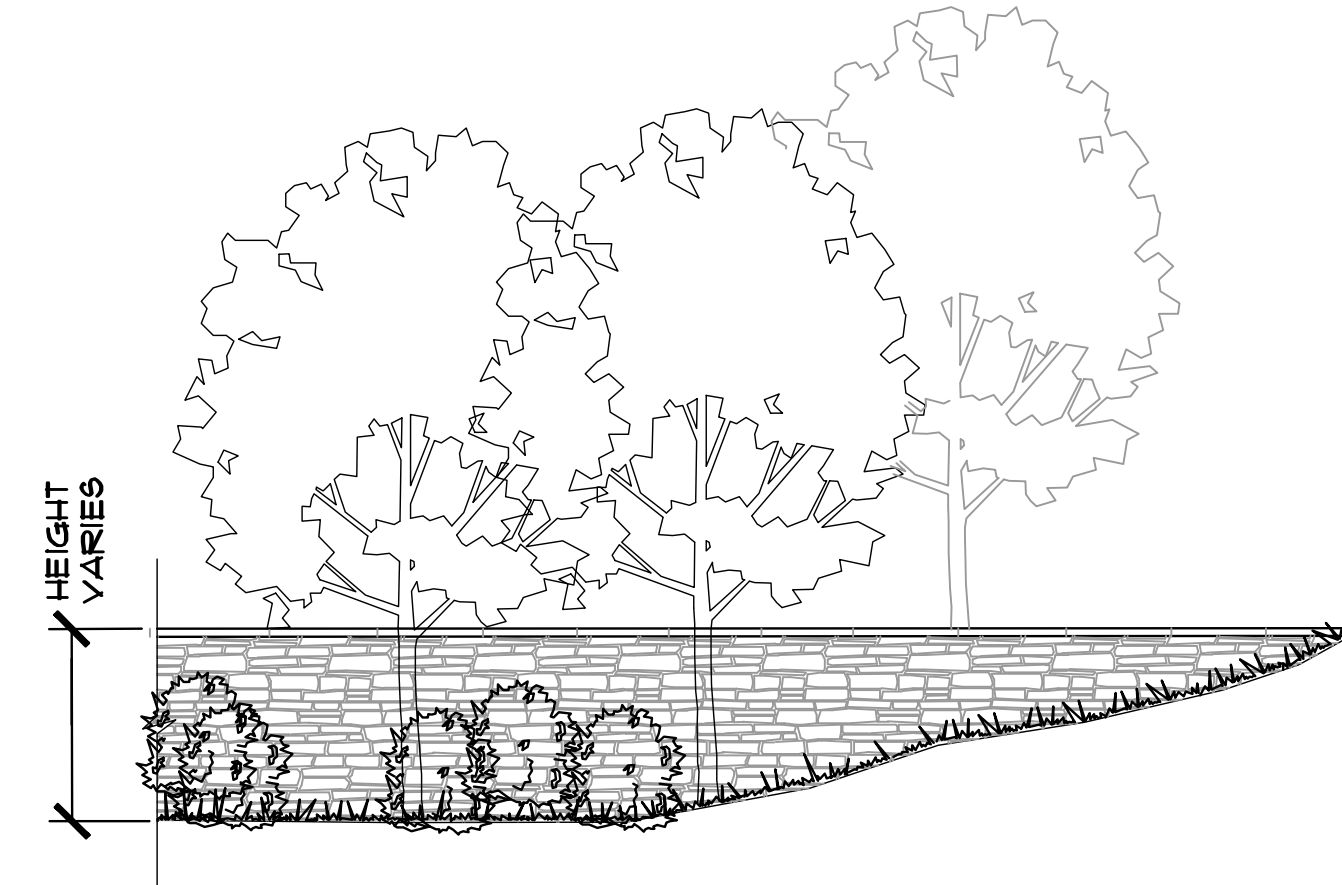

WALL TYPE 3
STONE VENEER WALL
FACING PLEASANT HILL ROAD
& HIGHWAY 24

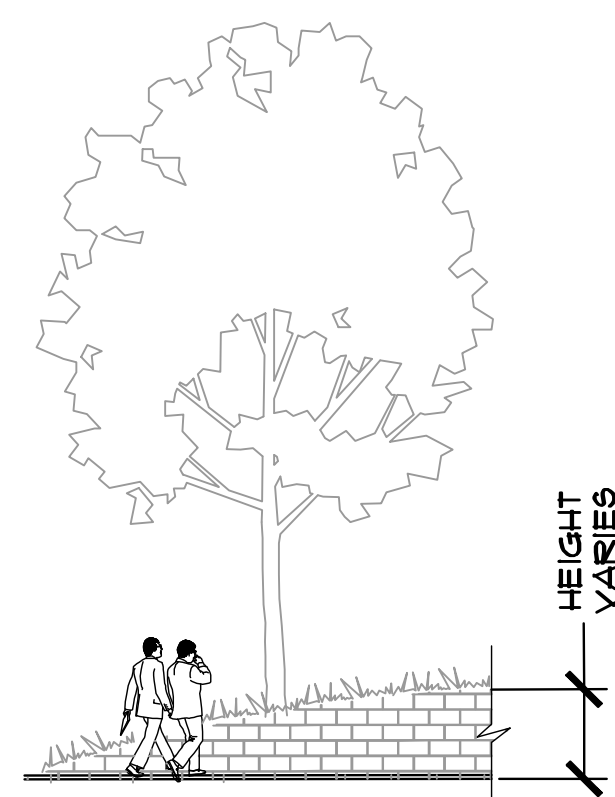

WALL TYPE 4
TAN BLOCK WALL-
WALLS ADJACENT TO
WOODLAND TRAIL

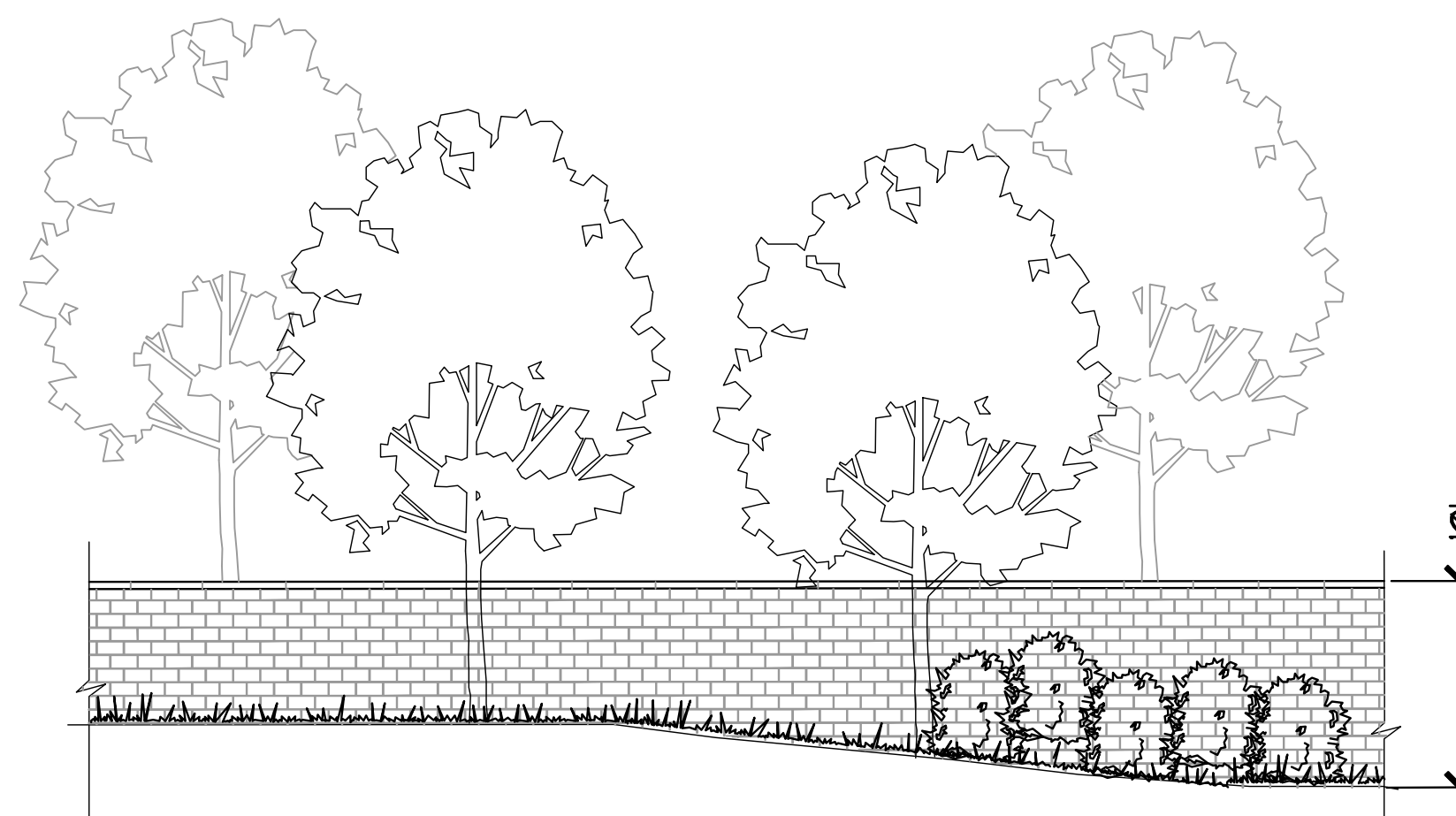

WALL 5
BLOCK WALL - TAN-
UPSLOPE INTERIOR

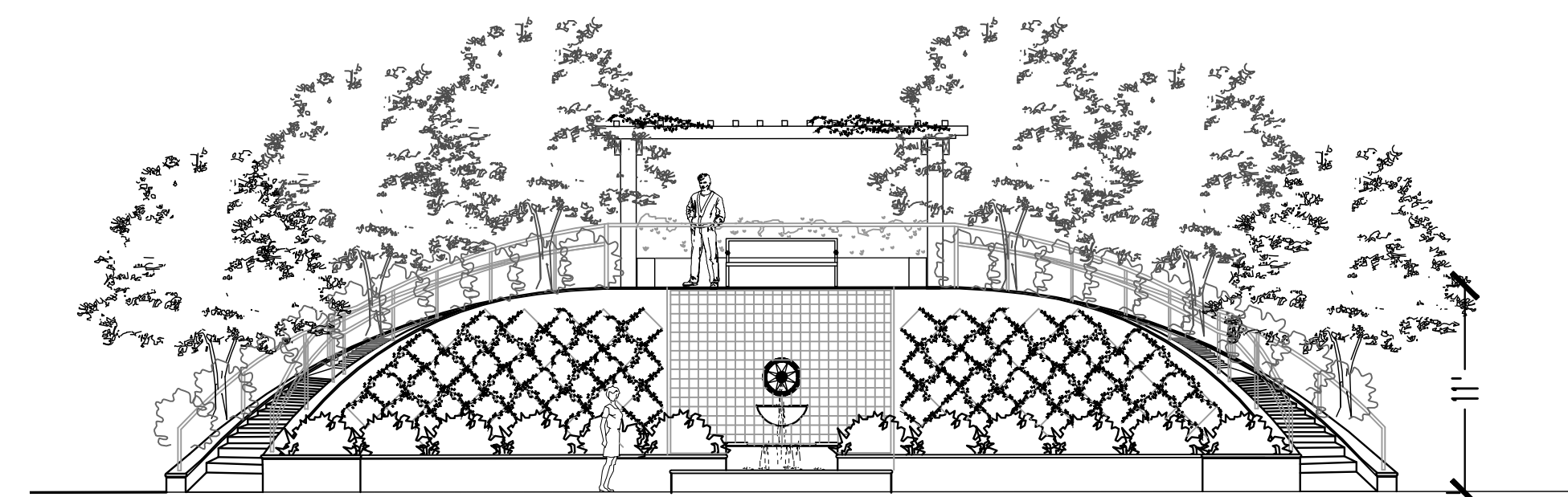

WALL 6-
STUCCO WITH CAST CAP
TILE ACCENTS- 11' MAX
VINE COVERED AT POOL AREA

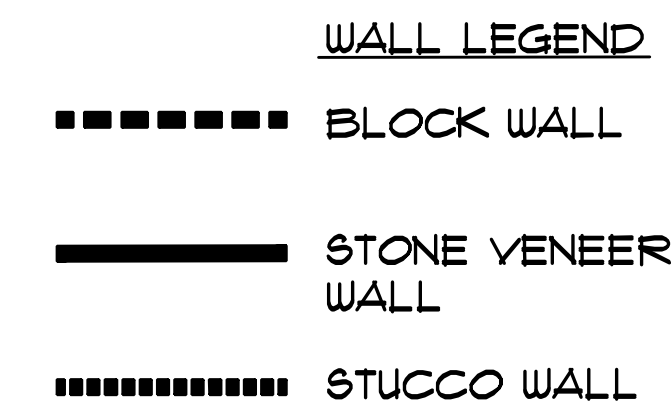
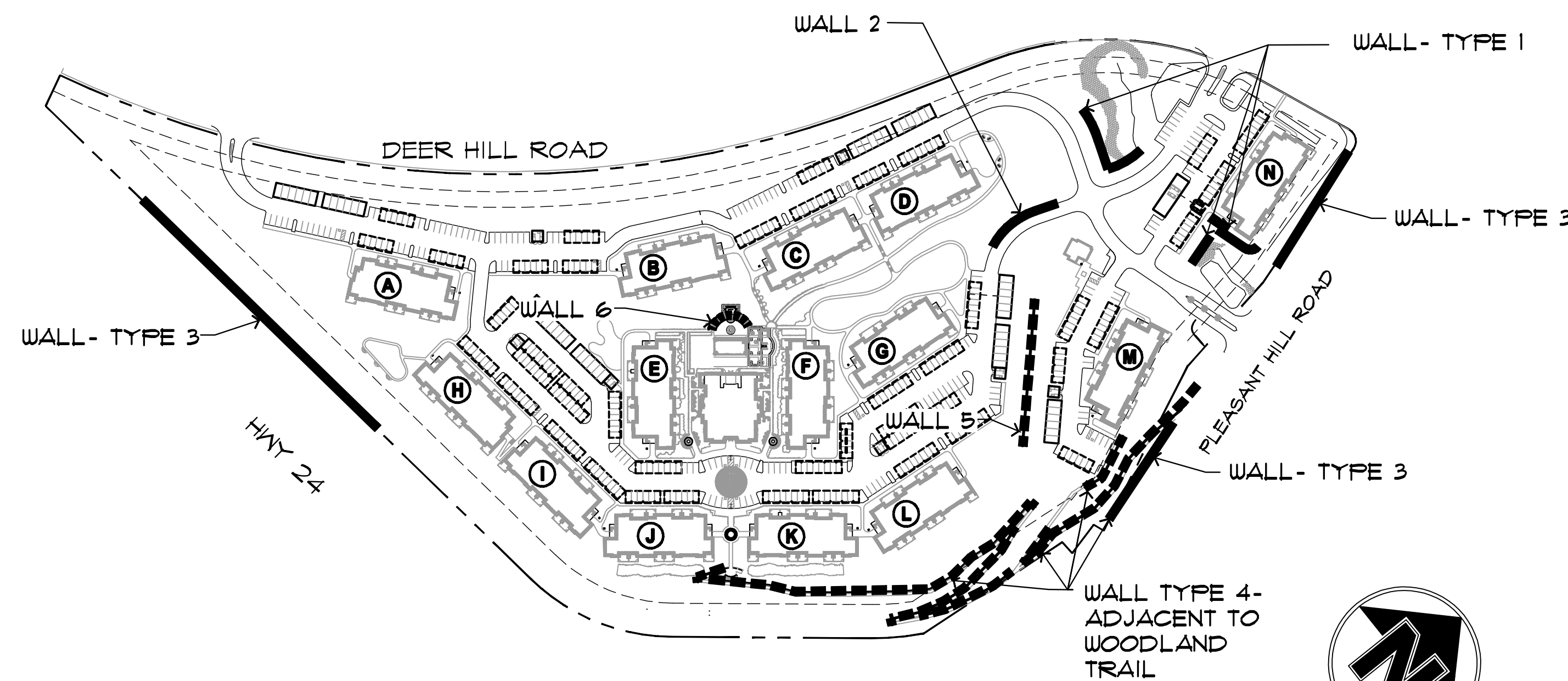
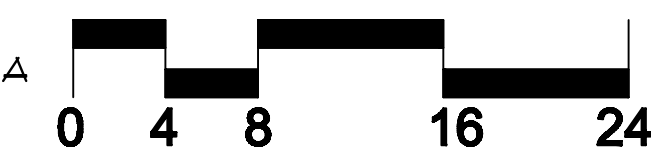

SCALE 1"=150'



Stone veneer retaining wall



Fireplace



Pool area trellis



Modular unit retaining wall

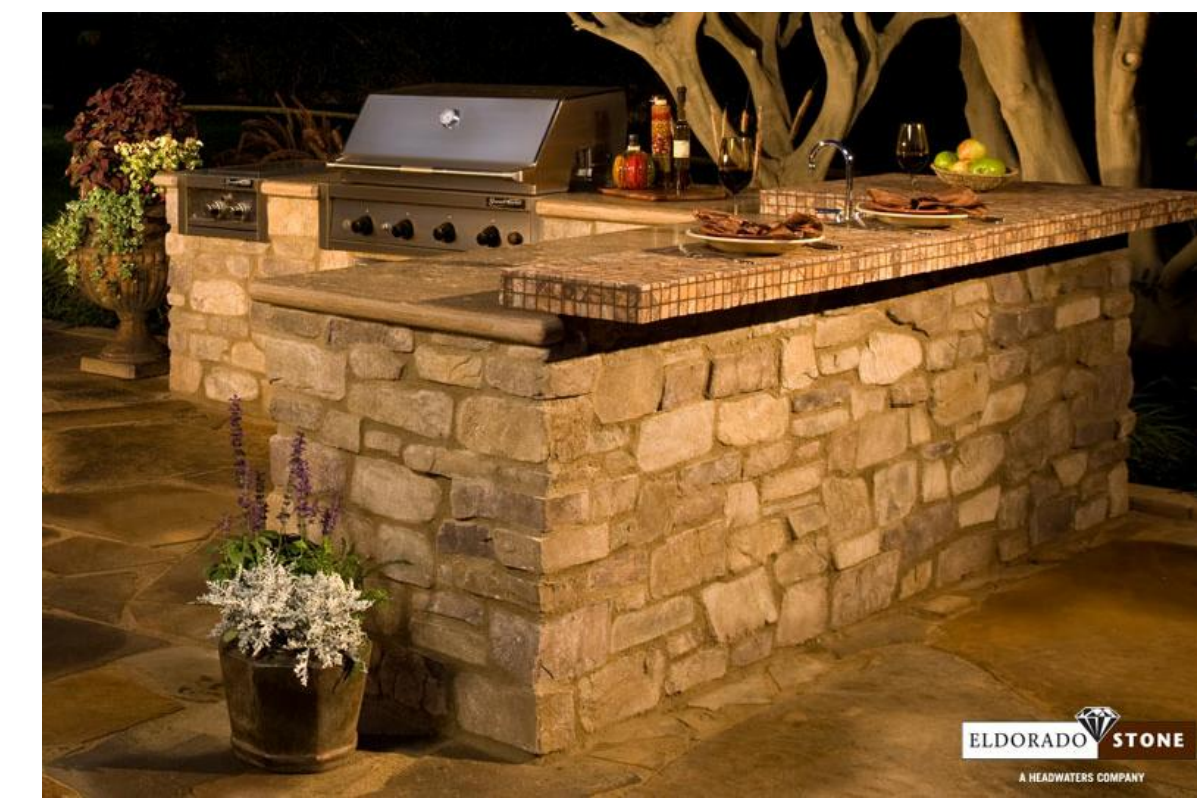

Barbeque



Pool area steps



Pots

Cardiff



Furniture

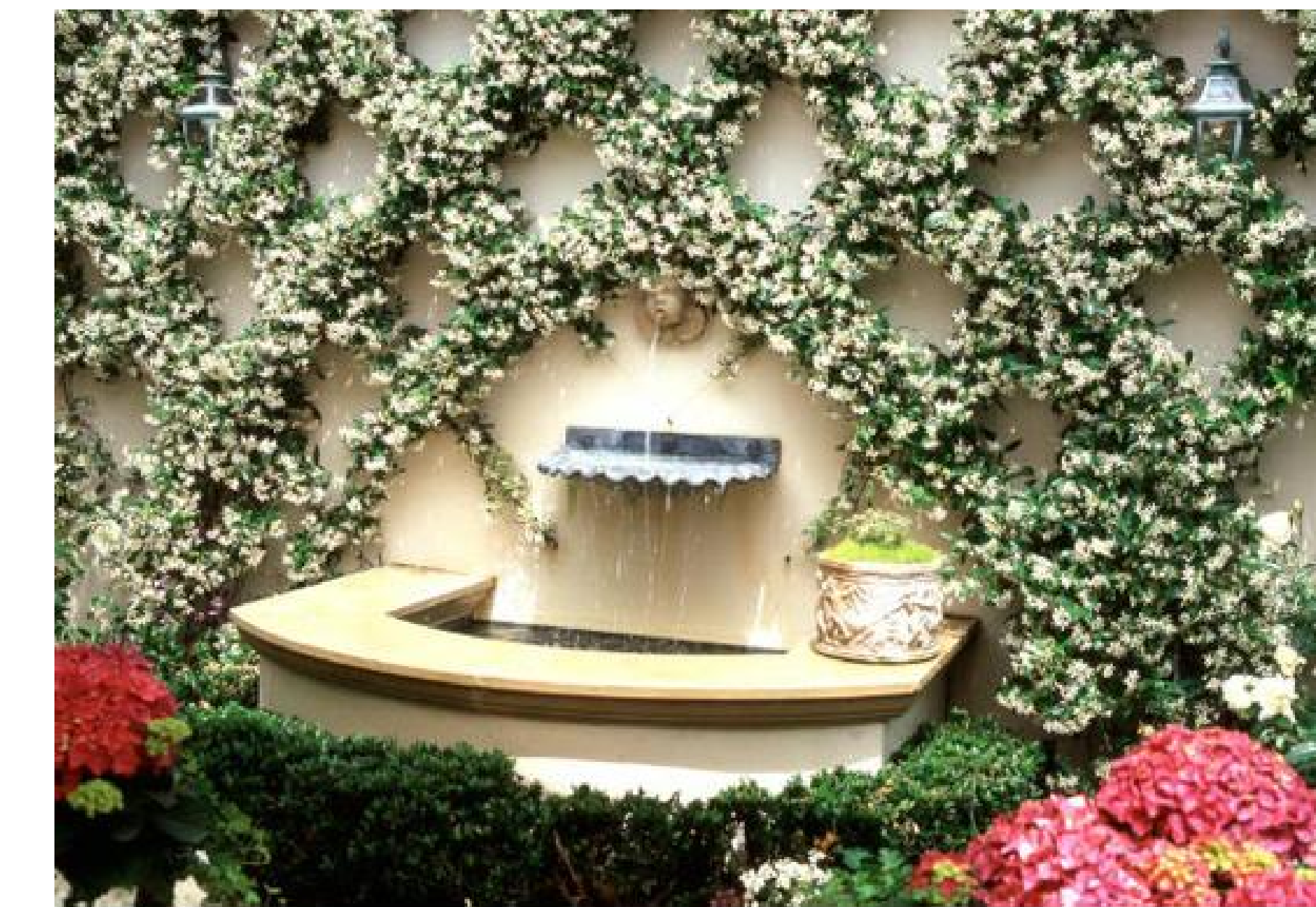

Pool Area Fountain

Project Images

NATIVE WOODLAND TREES



Arbutus menziesii

MADRONE TREE



Aesculus californica

CALIFORNIA BUCKEYE

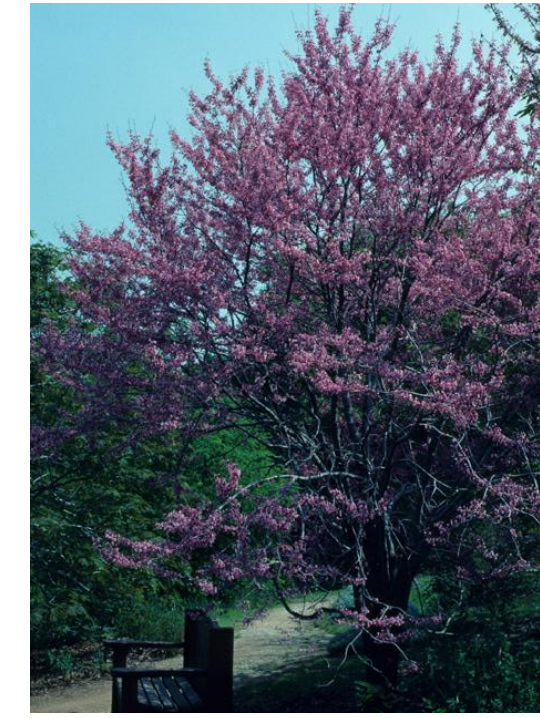

Cercis occidentalis

WESTERN REDBUD



Quercus lobata

COAST LIVE OAK



Platanus racemosa

CALIFORNIA RACEMOSA



Quercus lobata

VALLEY OAK



Umbellularia californica

CALIFORNIA BAY LAUREL

ORNAMENTAL TREES



Arbutus unedo

STRAWBERRY TREE



Crataegus species

HAWTHORN



Fraxinus a. 'Raywood'

RAYWOOD ASH



Olea e. 'Swan Hill'

FRUITLESS OLIVE



Prunus species

FLOWERING CHERRY



Pyrus calleryana

ORNAMENTAL PEAR



Quercus ilex

HOLLY OAK



Fistichia chinensis



CHINESE PISTACHE



Ulmus parvifolia

CHINESE ELM

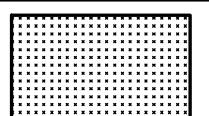
IRRIGATION HYDROZONE TABLE

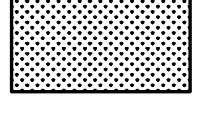
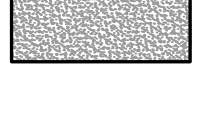
HYDROZONE	SQ/FT	% OF TOTAL AREA	PLANT TYPE	IRRIGATION TYPE
	136,636	62.1%	L	THESE AREAS WILL BE IRRIGATED WITH DRIP IRRIGATION AND OR HIGH EFFICIENCY ROTORS
	6,900	5.0%	L	THESE AREAS WILL BE IRRIGATED WITH DRIP IRRIGATION AND OR BUBBLERS
	28,800	21.0%	M	THESE AREAS WILL BE IRRIGATED WITH SPRAY IRRIGATION
	15,461	11.3%	H	THESE AREAS WILL BE IRRIGATED WITH SPRAY IRRIGATION
TREES	-	-	M	EACH TREE WILL RECEIVE 2 BUBBLERS
SHRUBS	-	-	L	EACH SHRUB WILL RECEIVE 1 BUBBLER OR 1 DRIP EMITTER PER PLANT

NOTE:
ALL PLANTING SHALL BE IRRIGATED WITH AN AUTOMATIC WATER CONSERVING IRRIGATION SYSTEM IN COMPLIANCE WITH THE CITY OF LAFAYETTE CONSERVATION ORDINANCES. ALL PLANTING AND IRRIGATION OPERATIONS SHALL COMPLY WITH THE CITY LAFAYETTE LANDSCAPE GUIDELINES.

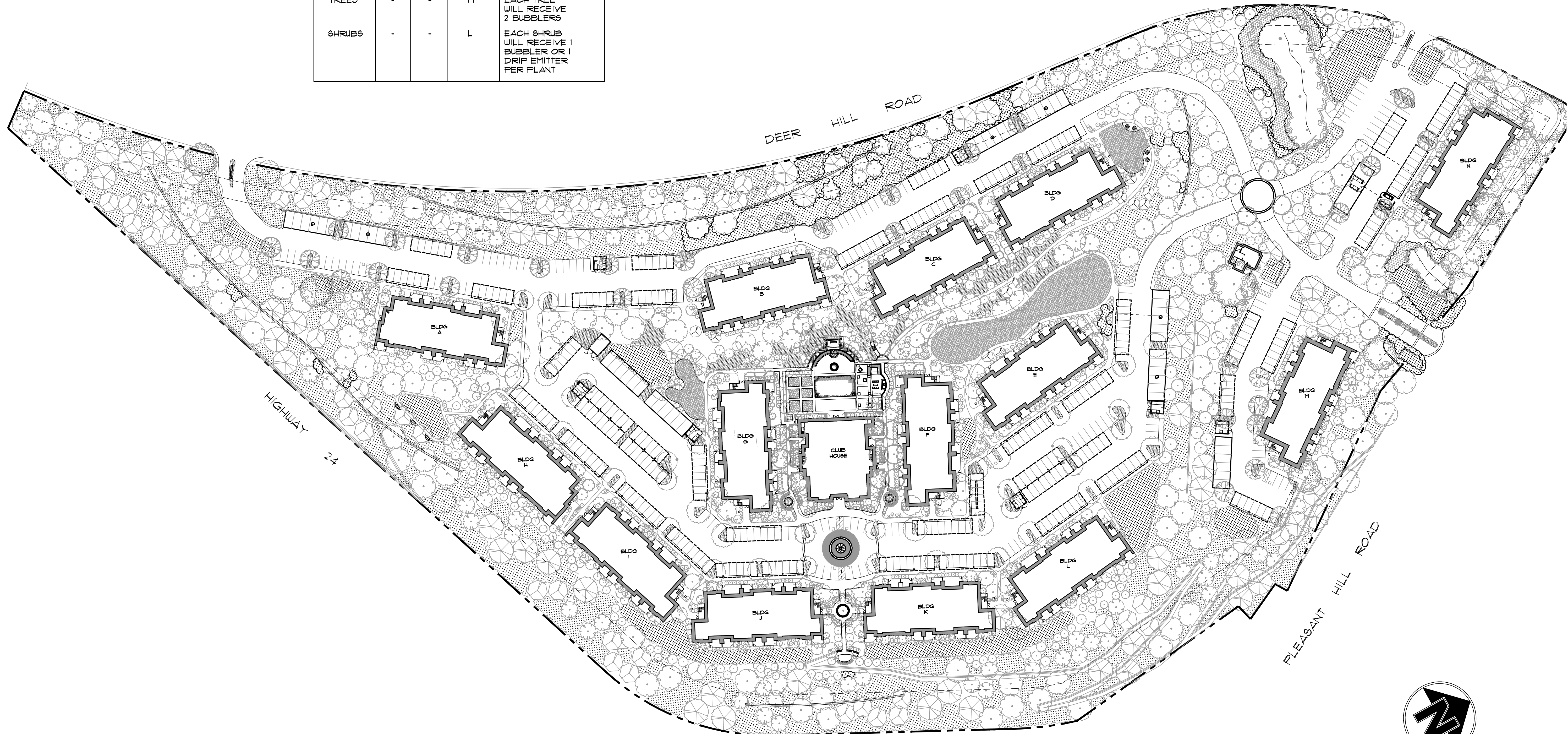

THE TERRACES OF LAFAYETTE
DEER HILL ROAD, LAFAYETTE, CALIFORNIA

Loving & Campos Architects Inc.
RESTRICTED ARCHITECTURAL DRAWINGS

The information, plans, designs, notes and arrangements shown on this drawing are confidential and may not be reproduced in whole or in part without the expressed written permission of LOVING & CAMPOS ARCHITECTS, INC. Drawings noted as Preliminary, Schematic and / or Concept contain information that is conceptual and subject to verification and/or change. The architect makes no claim for accuracy of conceptual information or of information supplied by others.

camp & camp
associates
planning & landscape architecture
email: tc@campandcamp.com

SCALE:
DATE: 3 / 21 / 2011

REVISIONS:
5 / 6 / 2011
9 / 21 / 2011

IRRIGATION PLAN

PROJECT NO. 10050

I-1

SHEET 1 OF

