

**ROAD WORK AHEAD
EXPECT TRAFFIC DELAY
XX/XX/XX TO XX/XX/XX**

- NOTES:**
1. SIZE: 42" H x 18" V.
 2. LETTERING: BLOCK UNIFORM, BLACK & 3" HIGH.
 3. PHRASE: CENTERED IN BOTH DIRECTIONS.
 4. SIGN BACKGROUND: ORANGE WITH BLACK 3/8" BORDER.
 5. INSTALL SIGN A MINIMUM OF 7 CALENDAR DAYS PRIOR TO PLANNED WORK. COVER OR REMOVE WHEN NOT NEEDED.

1
C10 **TRAFFIC DELAY SIGN** N.T.S.

**BUSINESSES OPEN
DURING CONSTRUCTION**

- NOTES:**
1. SIZE: 42" W x 24" H.
 2. LETTERING: BLOCK UNIFORM & 4" HIGH.
 3. PHRASE: CENTERED IN BOTH DIRECTIONS.
 4. SIGN BACKGROUND: GREEN ON NON-REFLECTIVE WHITE.
 5. MOUNTING: INSTALL ON PORTABLE A-FRAME IN A VISIBLE LOCATION ADJACENT TO WORK AREAS, AS DIRECTED BY THE ENGINEER.

2
C10 **BUSINESS OPEN SIGN** N.T.S.

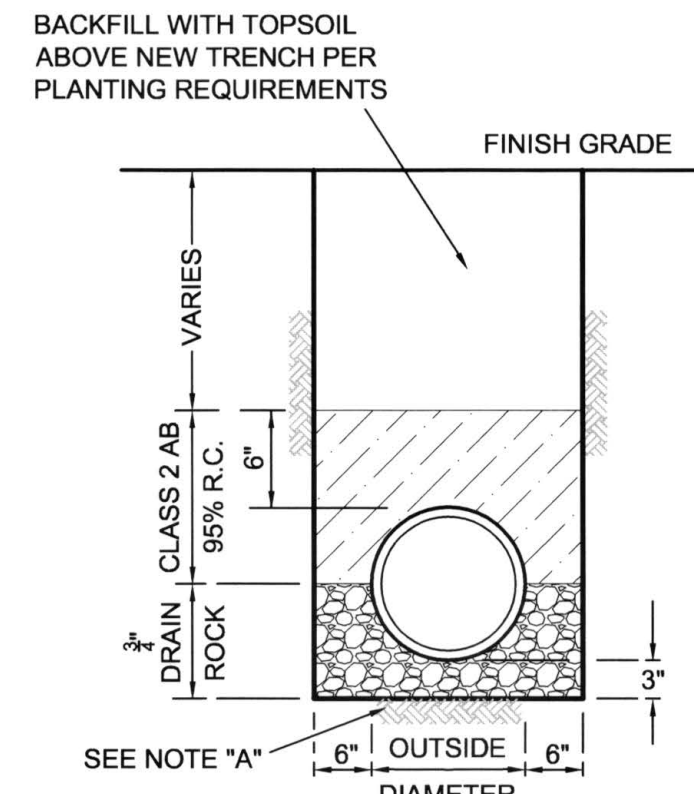

(IN LANDSCAPE AREAS)

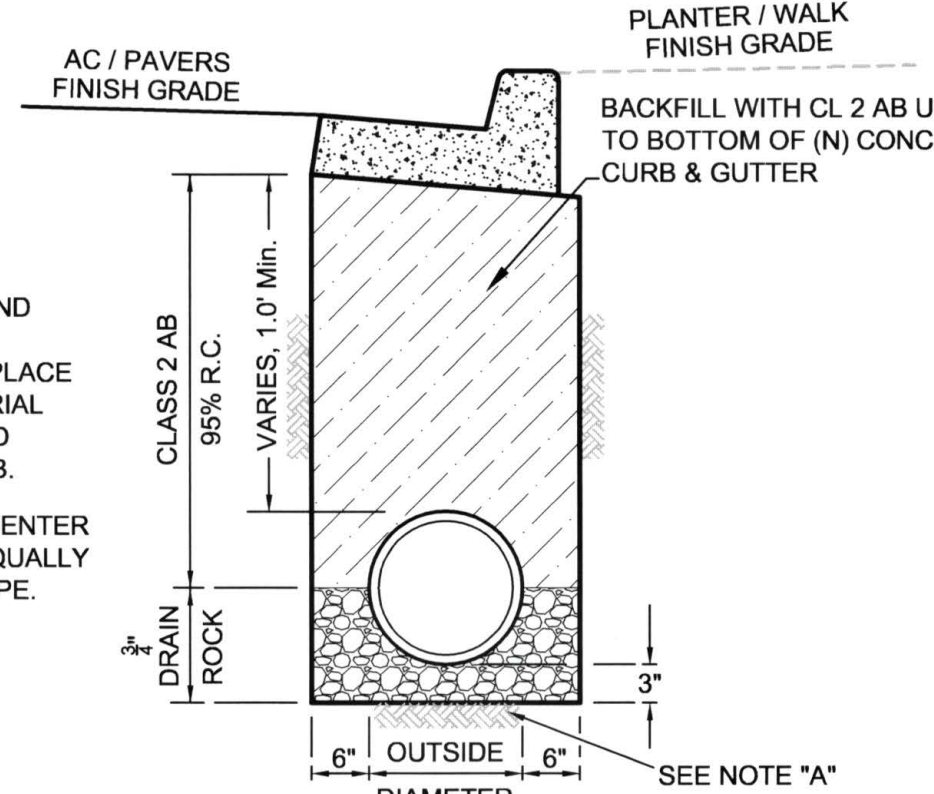

(IN ROADWAY OR WALKWAY AREAS)

STORMDRAIN TRENCH DETAIL
N.T.S.

- NOTES:**
- A. IF UNSUITABLE GROUND ENCOUNTERED, SUB-EXCAVATE AND PLACE 9" PERMEABLE MATERIAL PER STATE STANDARD SPEC. CLASS 1 TYPE B.
 - B. PLACE BACKFILL TO CENTER OF PIPE IN 6" LIFTS EQUALLY ON BOTH SIDES OF PIPE.

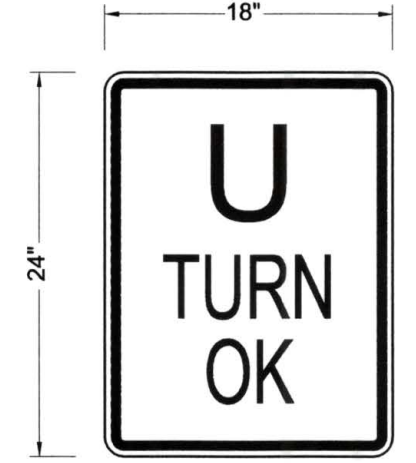

- MOUNTING OPTIONS:**
- [A] STREET LIGHT POLE MOUNTED SIGN
 - [B] POST MOUNTED SIGN
- SEE PLAN FOR LOCATION

NOTE: ALL HARDWARE SHALL BE PAINTED BLACK

NEW ROADWAY SIGN
(CONFORM TO R9-4 SIZE, LETTERING & COLORS)
N.T.S.

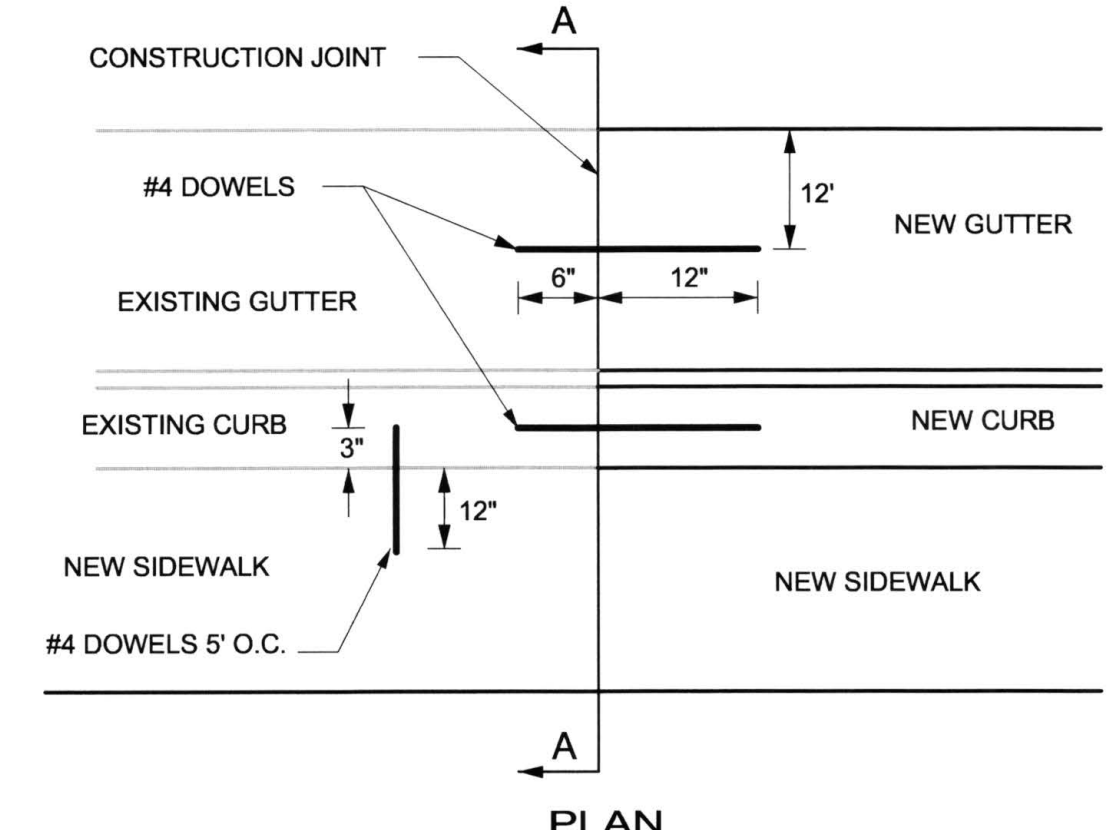

PLAN

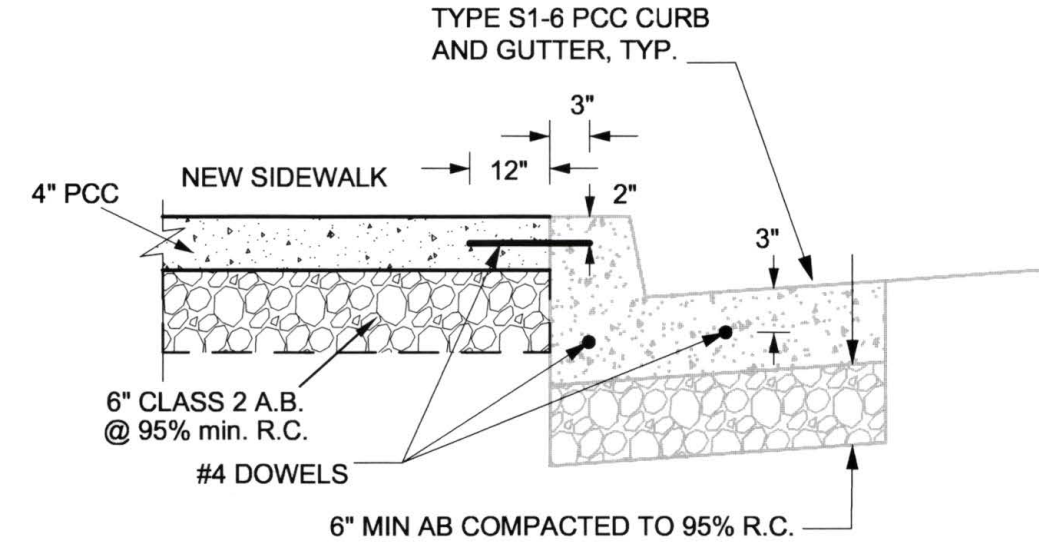

SECTION A-A

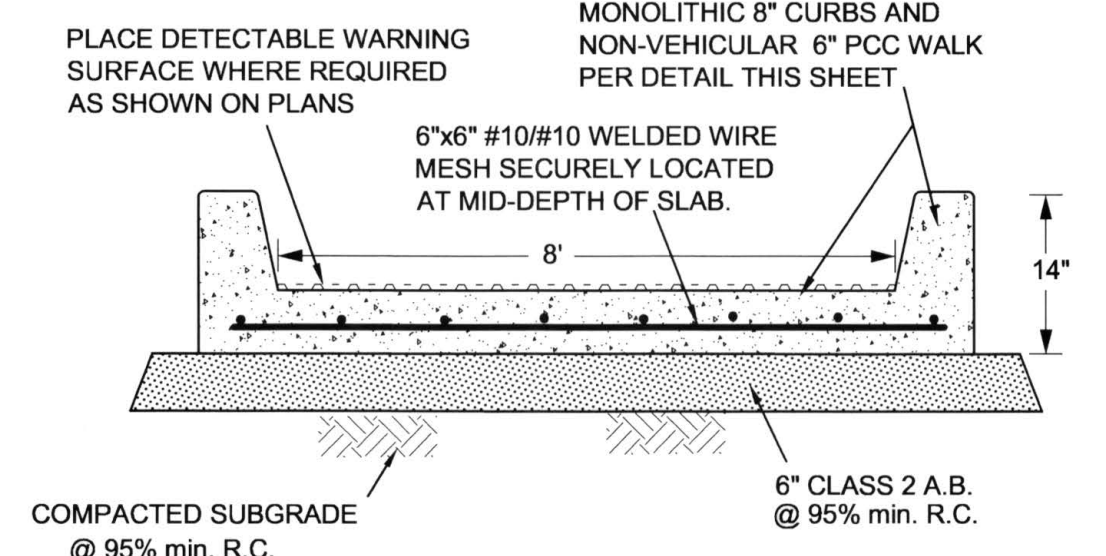

CONCRETE WALKWAY SECTION THROUGH MEDIAN ISLAND
N.T.S.

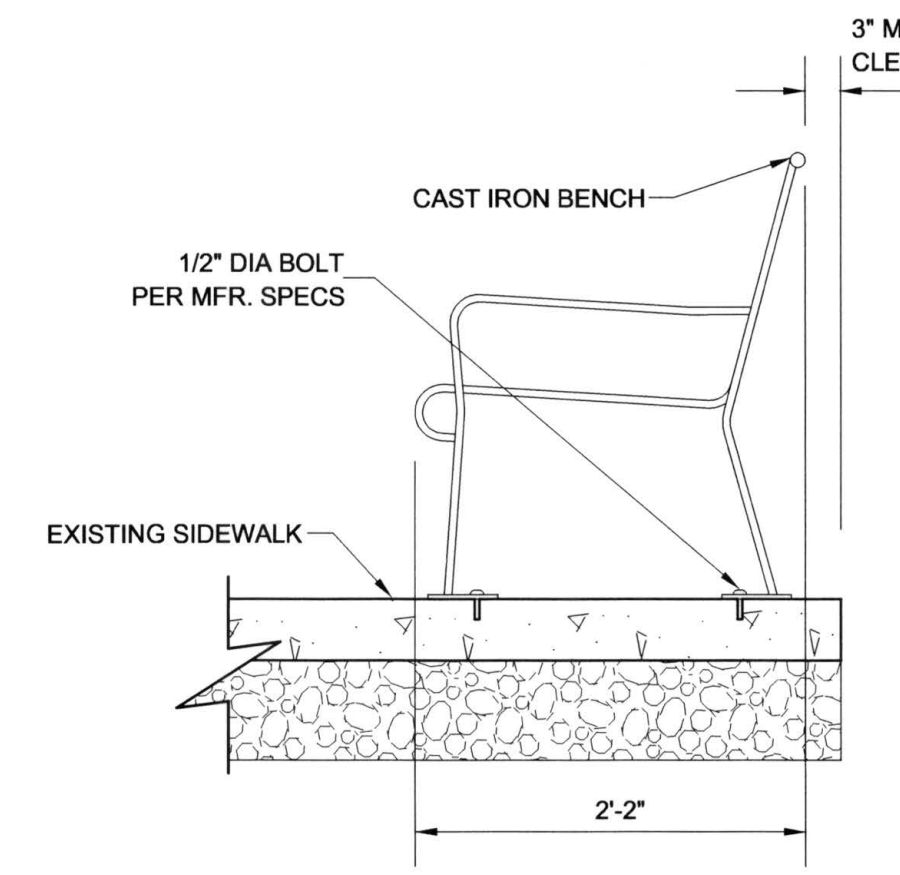

V
C10 **BENCH**
N.T.S.

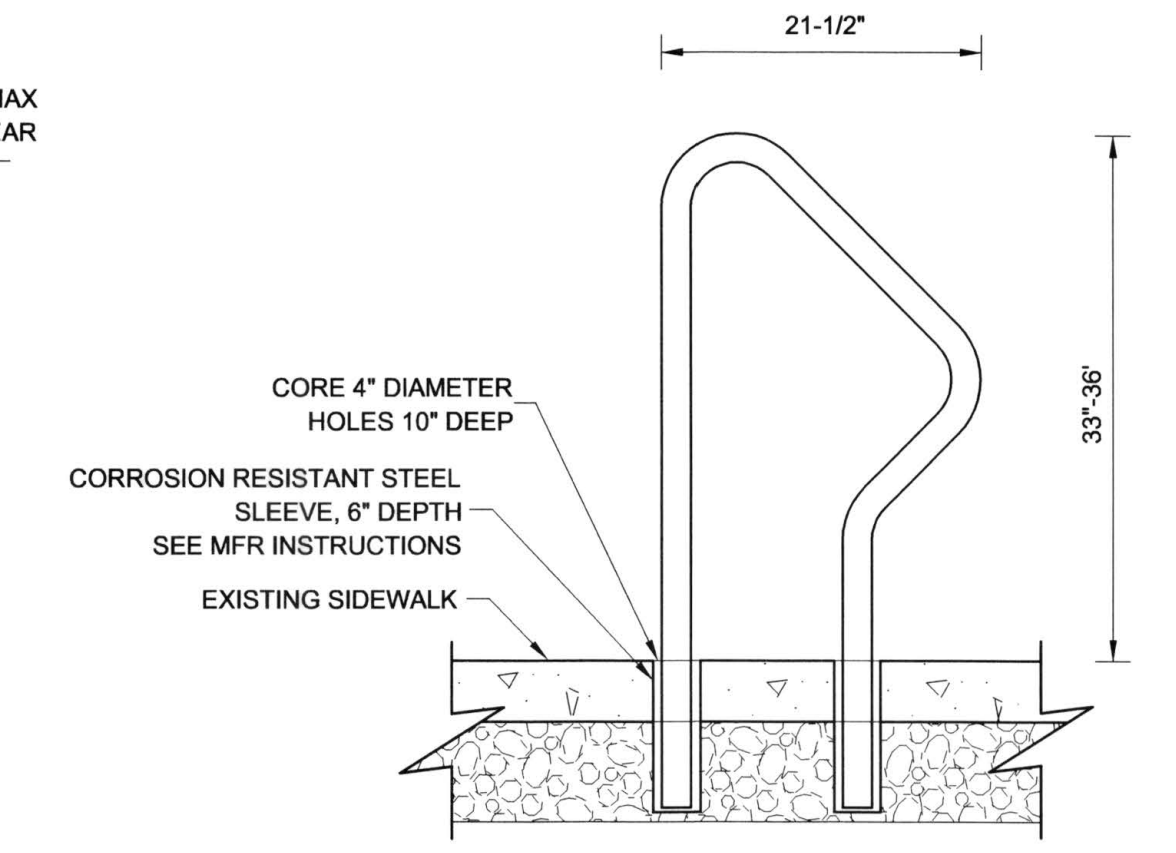

VI
C10 **BIKE RACK**
N.T.S.

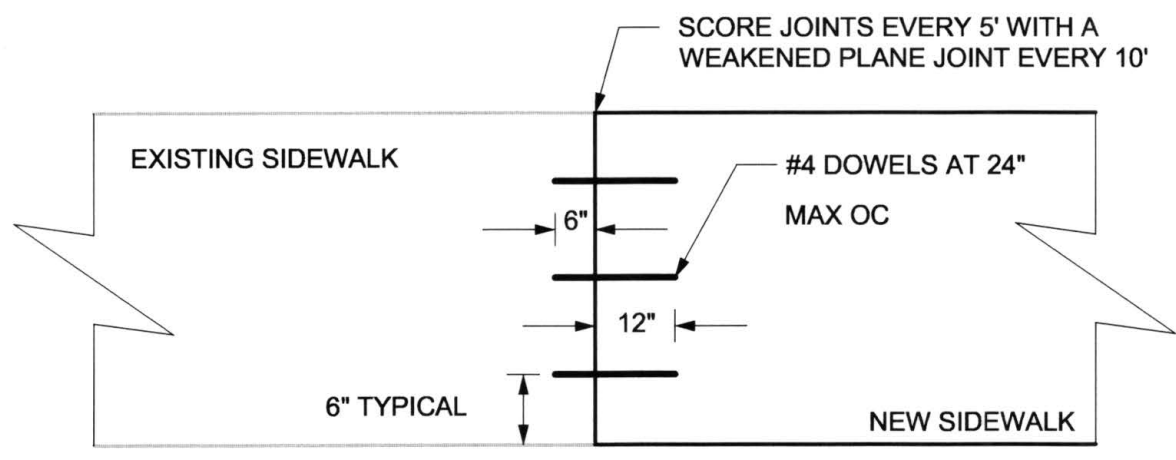

SIDEWALK PLAN VIEW

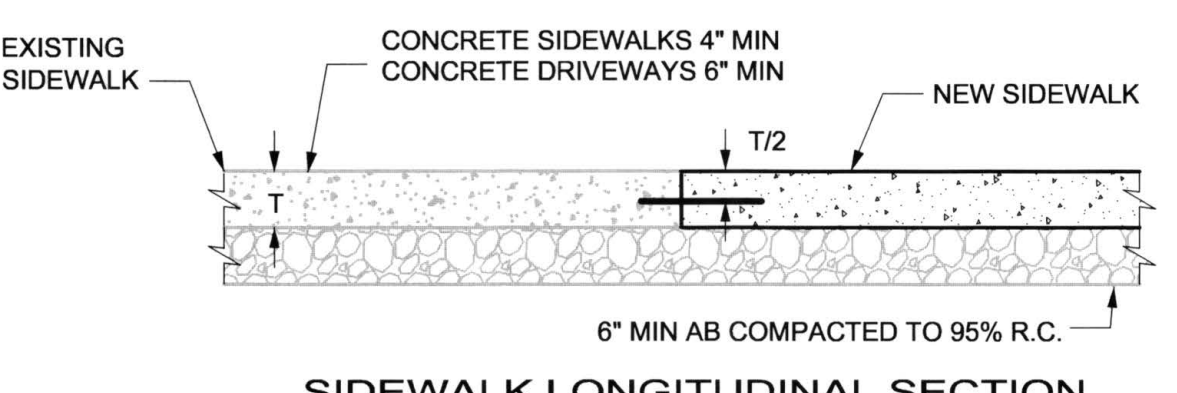

SIDEWALK LONGITUDINAL SECTION

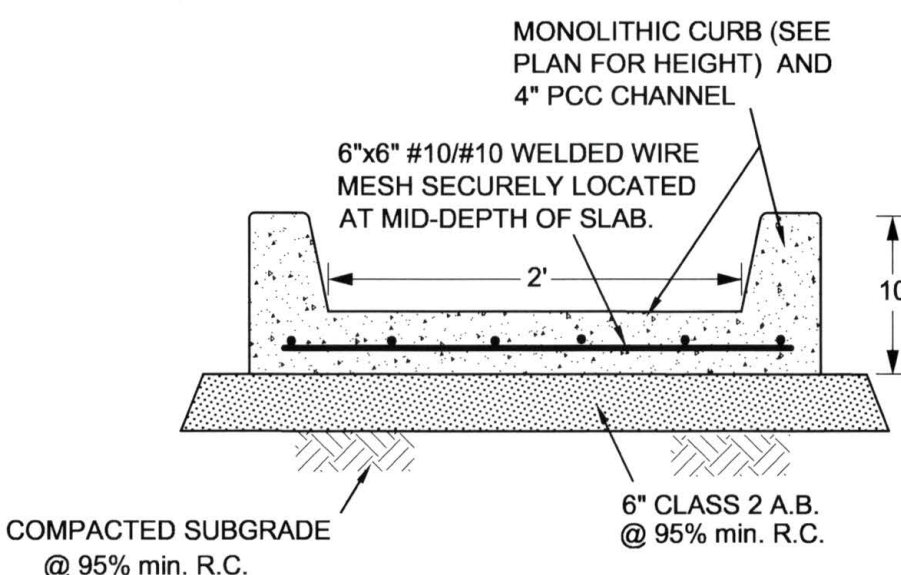

III
C10 **CONCRETE CHANNEL SECTION**
N.T.S.

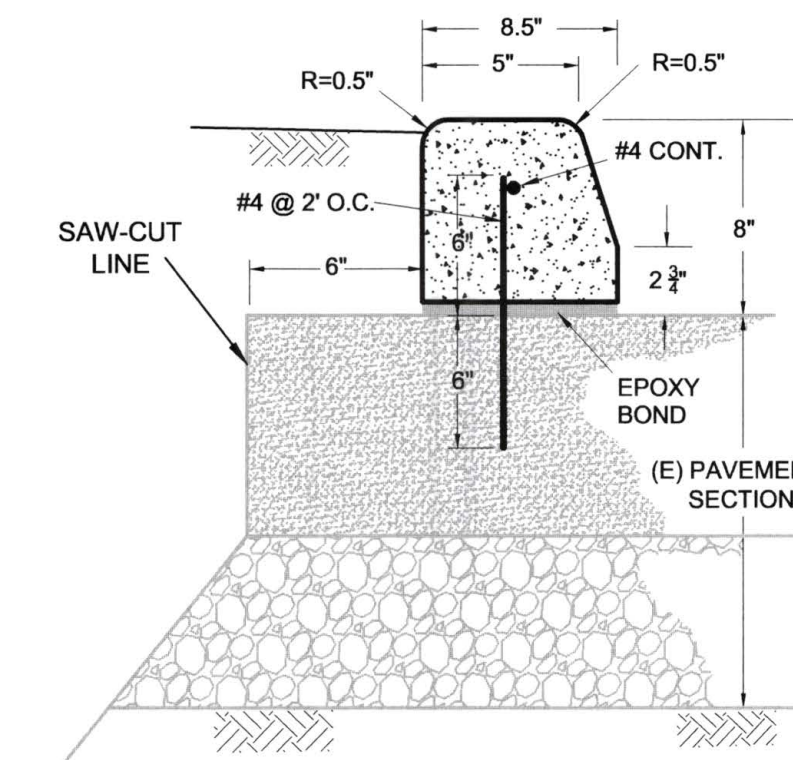

VII
C10 **MEDIAN CURB DETAIL**
N.T.S.

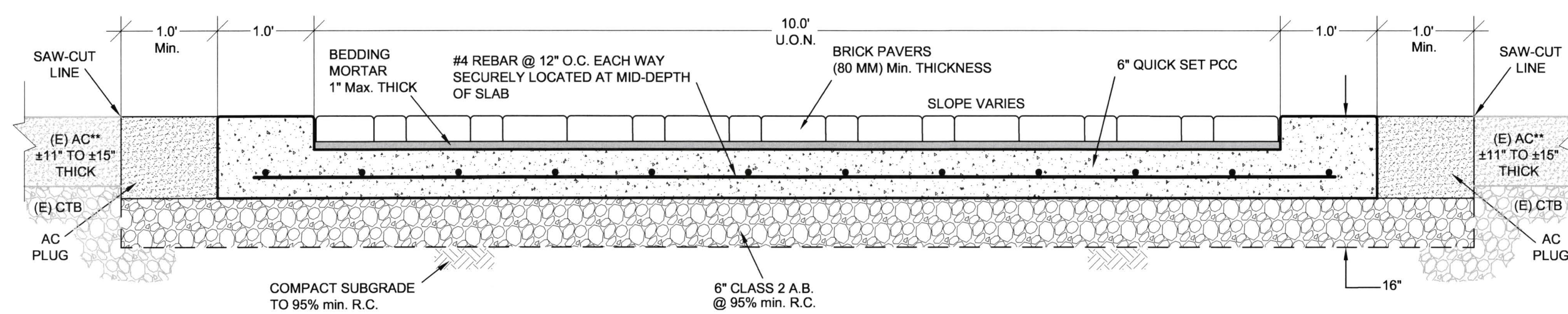

I
C10 **STANDARD BRICK PAVER CROSSWALK**
SCALE 1" = 1"
** SEE PLANS FOR BORE LOCATIONS

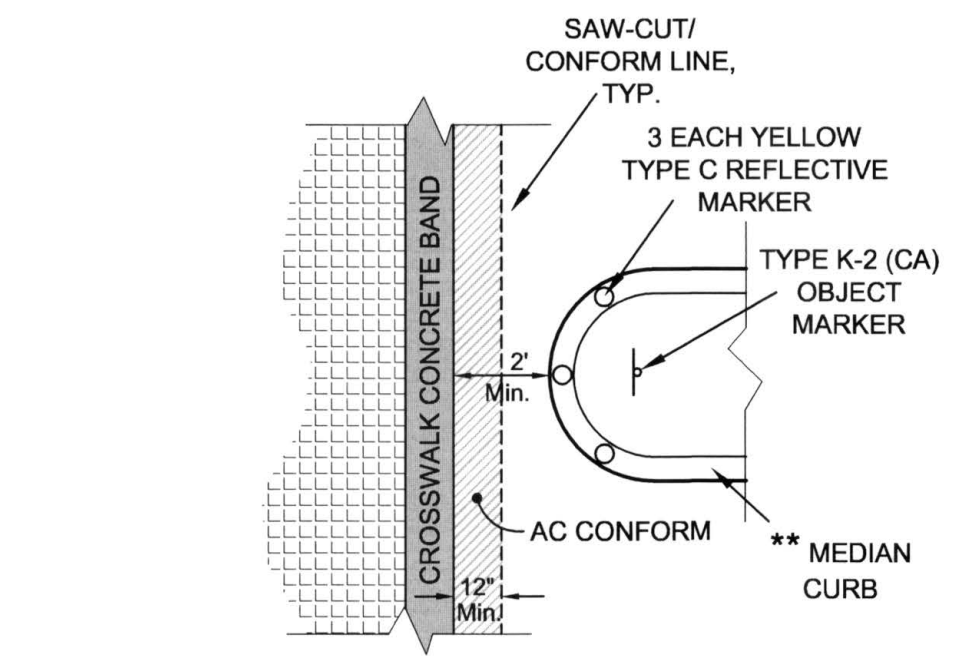

IV
C10 **TYPICAL AC CONFORM BETWEEN NEW CROSSWALK AND MEDIAN NOSE**
N.T.S.

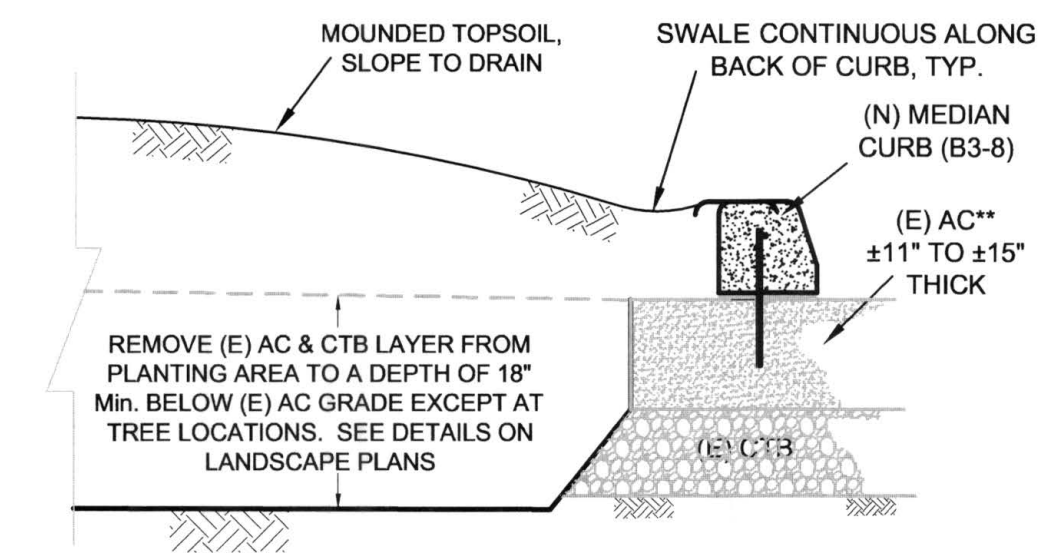

MEDIAN HALF CROSS SECTION
N.T.S.
** SEE PLANS FOR BORE LOCATIONS

NO.	DATE	BY	REVISIONS

SCALE	AS NOTED
DATE	08/30/2013
ENGINEER	H. N.
PROJECT NO.	12019

HUMANN COMPANY INC.
ENGINEERING - SURVEYING
1021 BROWN AVE. LAFAYETTE, CA 94549
PH (925)283-5000 FAX (925)283-3578

REGISTERED PROFESSIONAL ENGINEER
No. 29528
IZZAT S. NASHASHIBI R.C.E. 29528

CITY OF LAFAYETTE
PROJECT No. 014-9696
MOUNT DIABLO BLVD / FIRST STREET TO BROWN AVENUE
EAST END PED/BIKE AND STREETScape IMPROVEMENTS PROJECT
SECTIONS, DETAILS AND EROSION CONTROL NOTES & DETAILS
LAFAYETTE CALIFORNIA

REVIEWED BY:
CITY OF LAFAYETTE
TONY COE
ENGINEERING SERVICES MANAGER

SHEET **C10**
OF 11 SHEETS
PROJ. NO. 014-9696