

LEGEND

(X) DENOTES REFERENCED CONSTRUCTION NOTE No., AS SHOWN ON SHEET C01

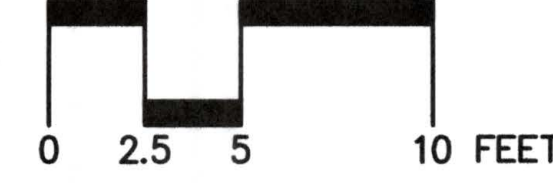
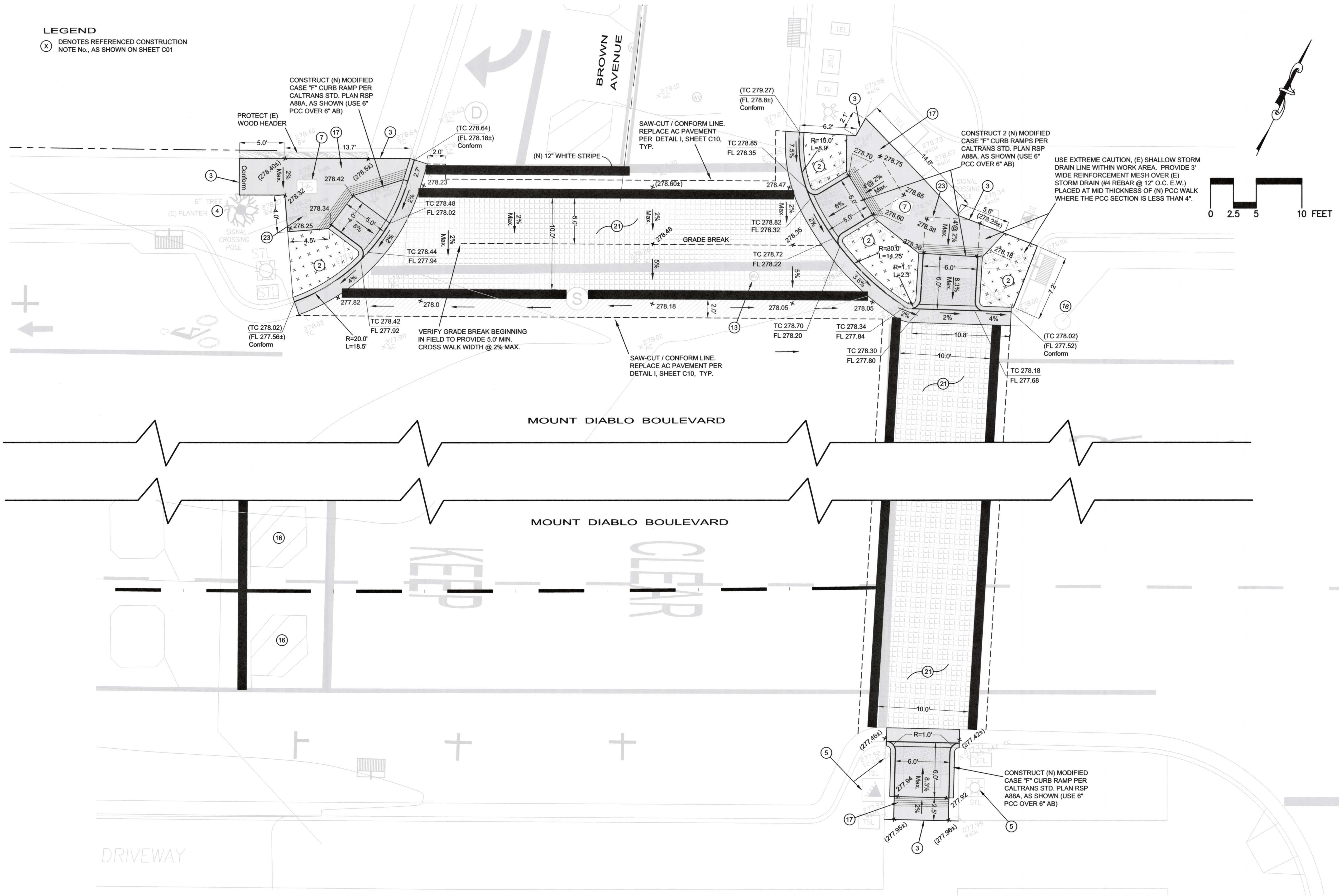

REVISIONS	SCALE	DATE	ENGINEER	JOB NO.
1"=5'	08/30/2013	H. N.	12019	

CITY OF LAFAYETTE
 PROJECT No. 014-9696
MOUNT DIABLO BLVD / FIRST STREET TO BROWN AVENUE
 EAST END PED/BIKE AND STREETSCAPE IMPROVEMENTS PROJECT
 BROWN AVENUE PED CROSSING
LAFAYETTE CALIFORNIA

HUMANN COMPANY INC.
 ENGINEERING - SURVEYING
 10211 BROWN AVE. LAFAYETTE, CA 94549
 PH (925)283-5000 FAX (925)283-3578

IZZAT S. NASHASHIBI
 IZZAT S. NASHASHIBI



REVIEWED BY:
CITY OF LAFAYETTE
 LAFAYETTE TONY COE
 ENGINEERING SERVICES MANAGER DATE

SHEET **C09**
 OF 11 SHEETS
 PROJ. NO. 014-9696