

SAW-CUT AT EXISTING SCORE MARKS AND REMOVE PLANTER CURB, TREE, SHRUBS AND CURB & GUTTER AS SHOWN, REUSE WITH DRIVEWAY APPROACH PER MODIFIED STD. DETAIL CA721 (USE 6" PCC OVER 6" AB), CONFORM TO ADJACENT DRIVEWAYS

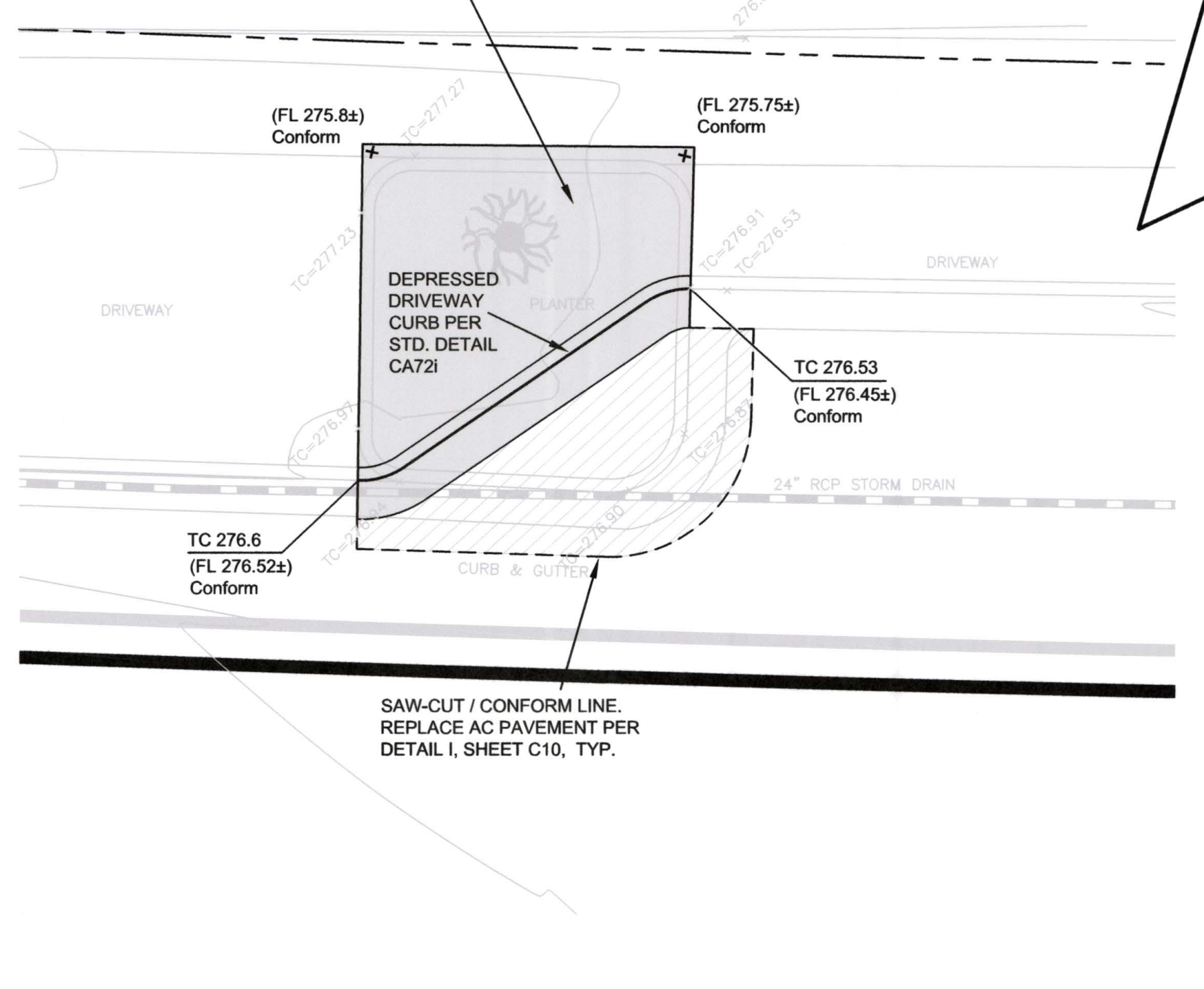

(E) VAULT TO REMAIN, CONFORM TO (E) LID / FRAME GRADES

CONSTRUCT (N) MODIFIED CASE "G" CURB RAMP PER CALTRANS STD. PLAN RSP A88A, AS SHOWN (USE 6" PCC OVER 6" AB)

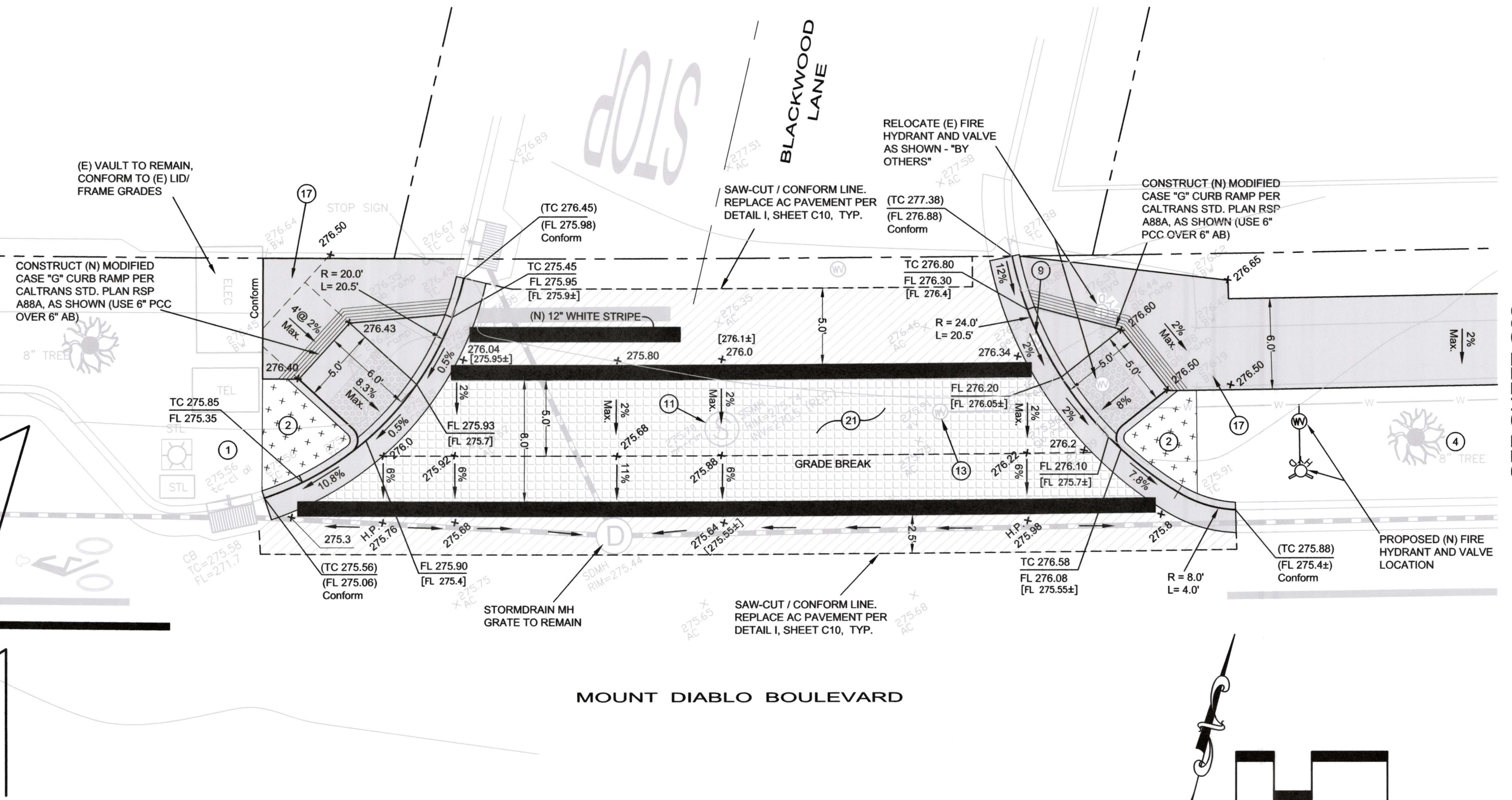

LEGEND
 (X) DENOTES REFERENCED CONSTRUCTION NOTE No., AS SHOWN ON SHEET C01

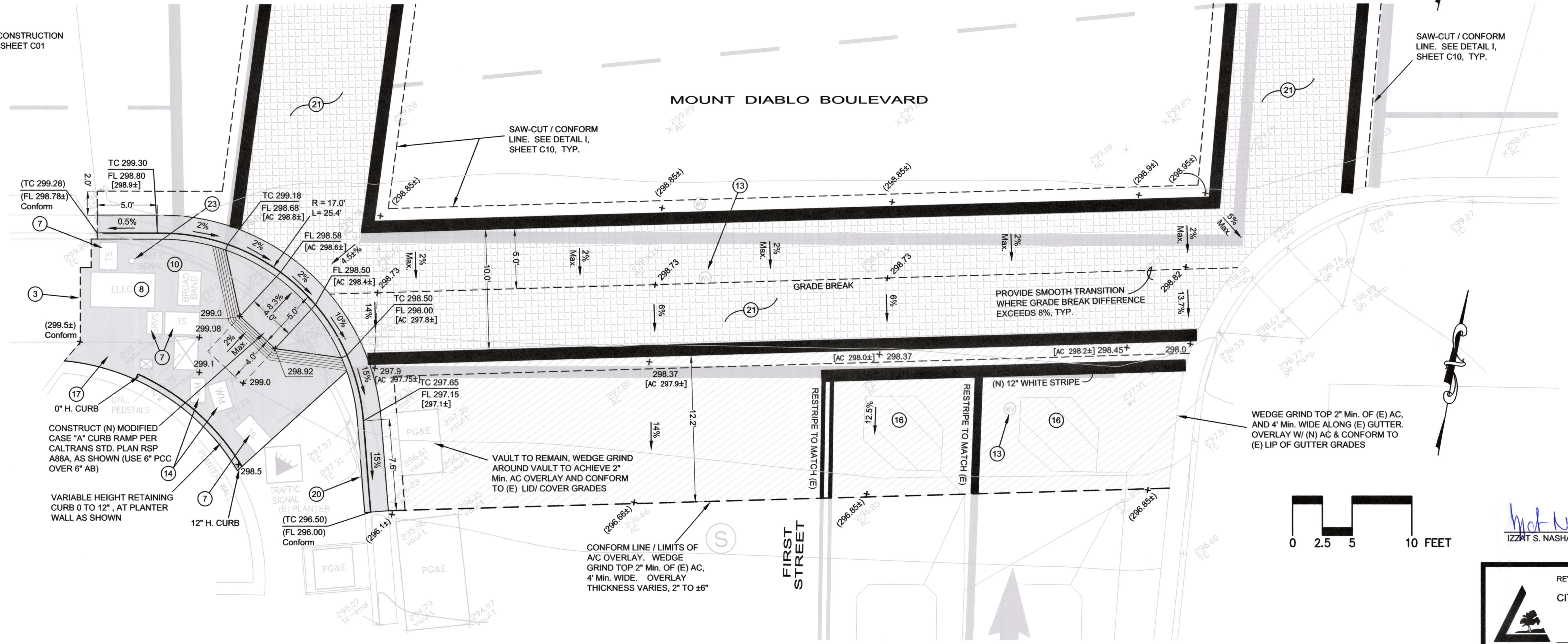

REVISIONS			
SCALE	DATE	ENGINEER	JOB NO.
1"=5'	08/30/2013	H. N.	12019

CITY OF LAFAYETTE
 PROJECT No. 014-9696
MOUNT DIABLO BLVD / FIRST STREET TO BROWN AVENUE
 EAST END PED/BIKE AND STREETSCAPE IMPROVEMENTS PROJECT
 FIRST STREET AND BLACKWOOD LANE PED CROSSING
LAFAYETTE CALIFORNIA

HUMANN COMPANY INC.
 ENGINEERING - SURVEYING
 10251 283RD W. FAX (925) 288-3578
 PH (925) 283-5000

REVIEWED BY:
CITY OF LAFAYETTE
 TONY COE
 ENGINEERING SERVICES MANAGER

SHEET **C06**
 OF 11 SHEETS
 PROJ. NO. 014-9696