

LEGEND

- ① GRIND AND REMOVE PORTION OF (E) STRIPING AS SHOWN
- ② GRIND SQUARE BLOCK AND REMOVE (E) ARROW
- ③ GRIND AND REPLACE (E) BIKE LANE STRIPING AS SHOWN
- ⊗ DENOTES REFERENCED CONSTRUCTION NOTE No., AS SHOWN ON SHEET C01
- A "U TURN OK" SIGN MOUNTED ON STREET LIGHT POLE, AS SHOWN ON SHEET C10
- B "U TURN OK" SIGN & POST, AS SHOWN ON SHEET C10

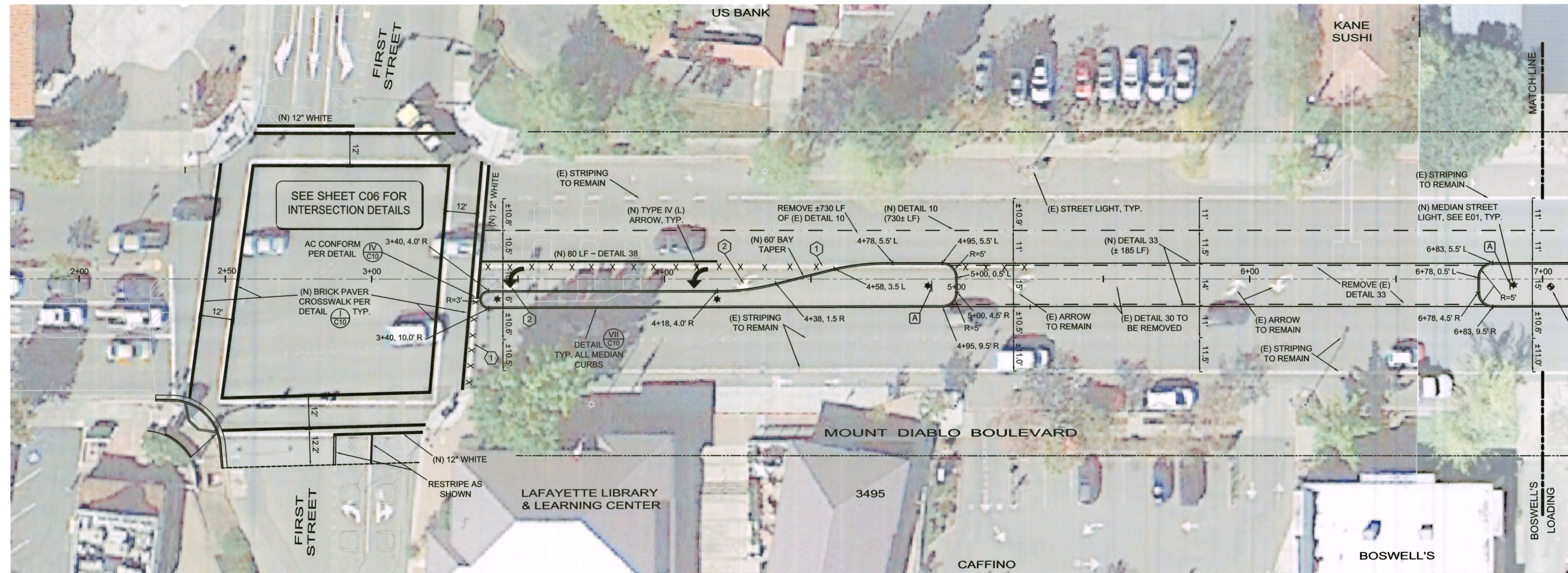
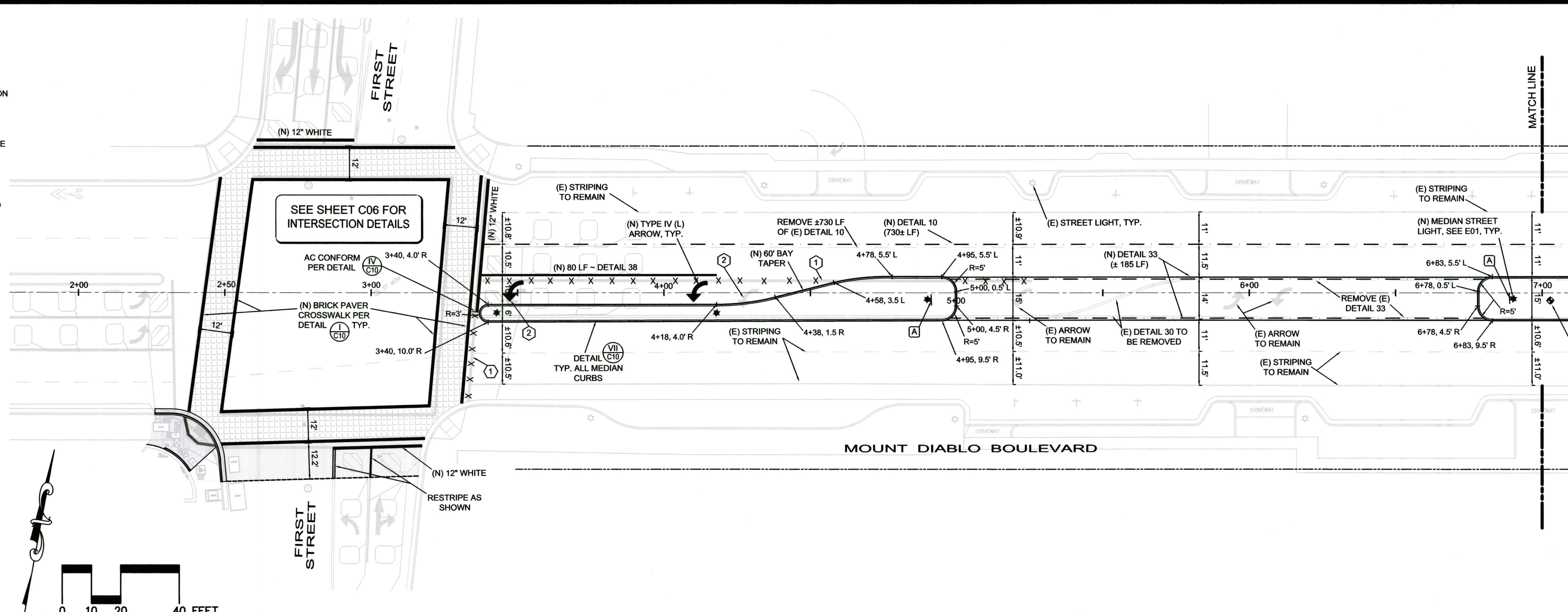

SEE SHEET C03

NO.	DATE	BY	REVISIONS

SCALE	1" = 20'
DATE	08/30/2013
ENGINEER	H. N.
PROJECT NO.	12019

HUMANN COMPANY INC.

ENGINEERING - SURVEYING
1021 BROWN AVE. LAFAYETTE, CA 94549
PH (925)283-5000 FAX (925)283-3578

REGISTERED PROFESSIONAL ENGINEER
No. 29528
CIVIL
STATE OF CALIFORNIA

IZZAT S. NASHASHIBI R.C.E. 29528

CITY OF LAFAYETTE
PROJECT No. 014-9696
MOUNT DIABLO BLVD / FIRST STREET TO BROWN AVENUE
EAST END PED/BIKE AND STREETSCAPE IMPROVEMENTS PROJECT
LAFAYETTE CALIFORNIA

STA: 2+00 TO 7+00

REVIEWED BY:
CITY OF LAFAYETTE

LAFAYETTE
TONY COE
ENGINEERING SERVICES MANAGER

DATE

SHEET **C02**
OF 11 SHEETS

PROJ. NO. 014-9696