

EASTERN DEER HILL PLANNING AREA  
PARCEL 27 VISUAL ANALYSIS

PARCEL 27

THE TERRACES OF LAFAYETTE

AMD FAMILY TRUST | O'BRIEN LAND COMPANY, LLC | ELCA ARCHITECTS

AUGUST 19, 2011

ORG1-63  
cont.

# Table of Contents

Aerial Context Map	1
Grading Disturbance	2
On-Site Photos	3
Off-Site Photos	4-6
Aerial Photo	7
Aerial Simulations	8-9
View from Site	10
Visibility Exhibit from Eastern Deer Hill Opportunities and Constraints Analysis	11
Hillside Overlay District Map Exhibit	12
Aerial Views of Ridge	13-24

**ORG1-63  
cont.**

AMD FAMILY TRUST

O'BRIEN LAND COMPANY, L.L.C.



THE TERRACES OF LAFAYETTE

APN 232-150-027 | 3233 DEAR HILL ROAD, LAFAYETTE, CALIFORNIA 94549



- CLASS I RIDGE (400' SETBACK)
- CLASS II RIDGE (250' SETBACK)
- IMPLIED RIDGE (NO FEATURE)
- NO RIDGE (HODM BASED ON OUTDATED TOPO)
- RIDGE SETBACK
- RIDGE POINT REFERENCE (REFER TO ENGEO REPORT)



THE TERRACES OF LAFAYETTE  
 401-735-1100  
 11000 W. 10TH AVE., SUITE 1000, DENVER, CO 80231  
 AERIAL CONTEXT MAP

AMD FAMILY TRUST | O'BRIEN LAND COMPANY, L.L.C. | JLCA ARCHITECTS

ORG1-63  
 cont.

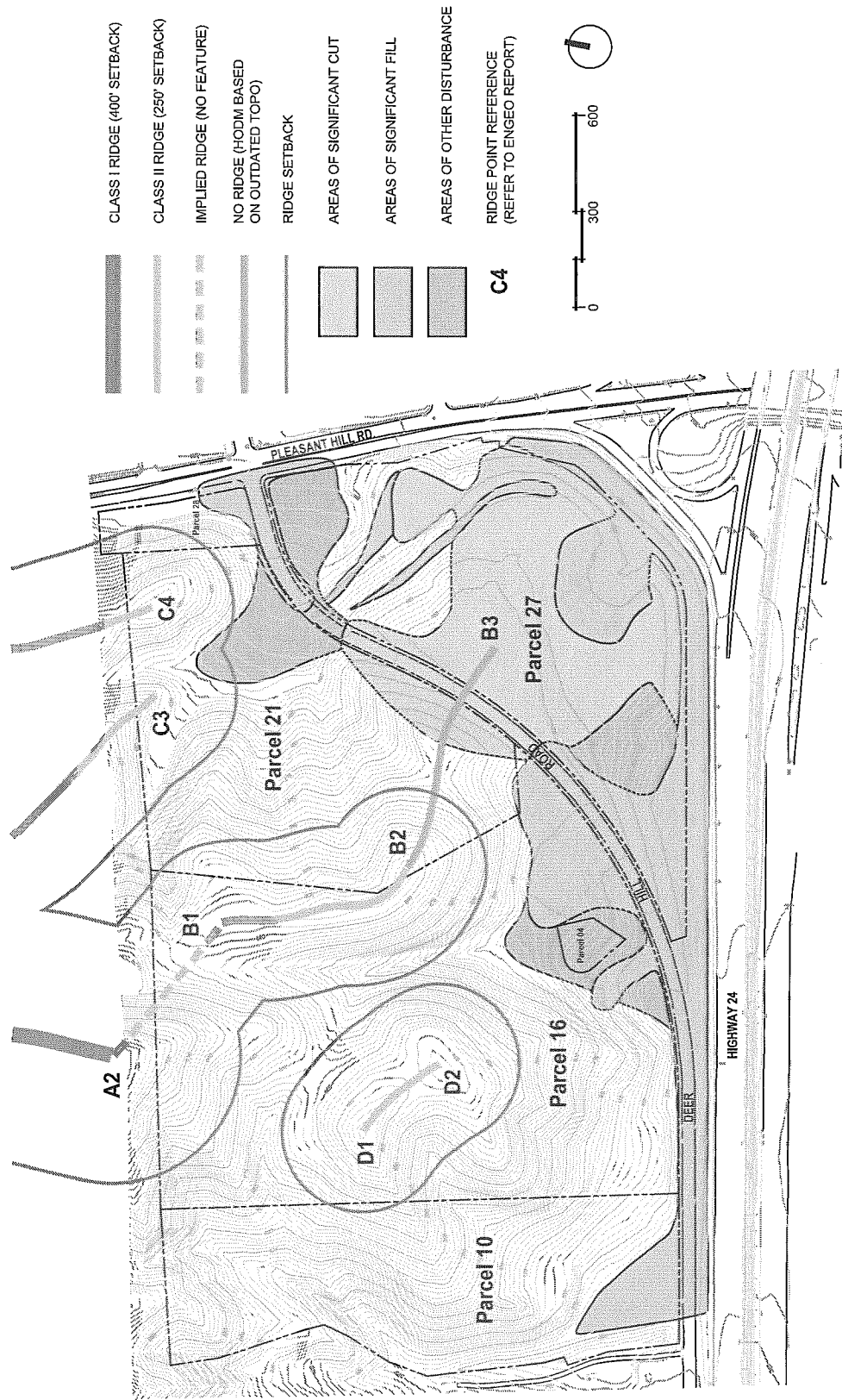

- CLASS I RIDGE (400' SETBACK)
- CLASS II RIDGE (250' SETBACK)
- IMPLIED RIDGE (NO FEATURE)
- NO RIDGE (HODM BASED ON OUTDATED TOPO)
- RIDGE SETBACK
- AREAS OF SIGNIFICANT CUT
- AREAS OF SIGNIFICANT FILL
- AREAS OF OTHER DISTURBANCE
- RIDGE POINT REFERENCE (REFER TO ENGEO REPORT)



O'BRIEN LAND COMPANY, LLC.

AMD FAMILY TRUST

THE TERRACES OF LAFAYETTE  
 APR 27, 2015 (REV. 2/15) | 1275 DEER HILL WAY, LAFAYETTE, CALIFORNIA 94508

**EASTERN DEER HILL PLANNING AREA - AREAS OF GRADING DISTURBANCE**

ORG1-63  
 cont.

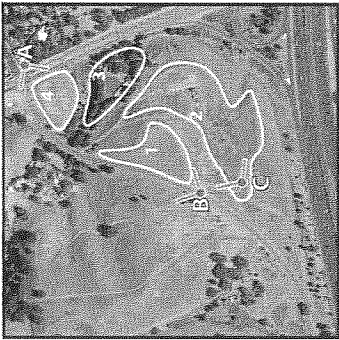

**KEY MAP**  
 Letters = View Locations  
 Numbers = Terrace Locations

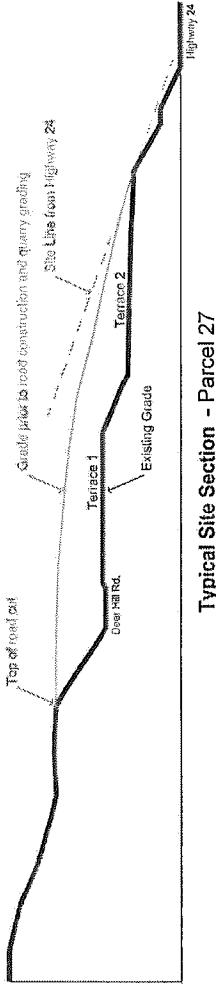

Typical Site Section - Parcel 27

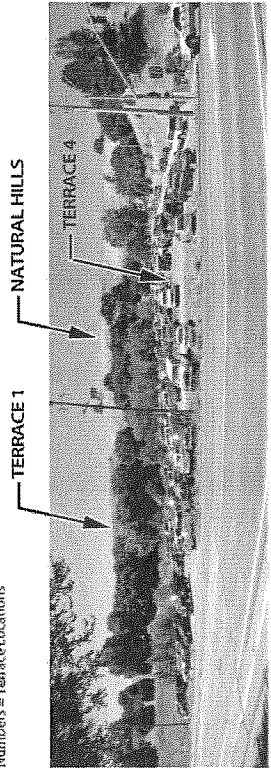

View A

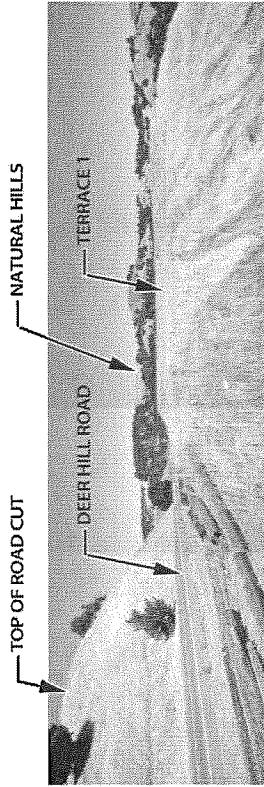

View B

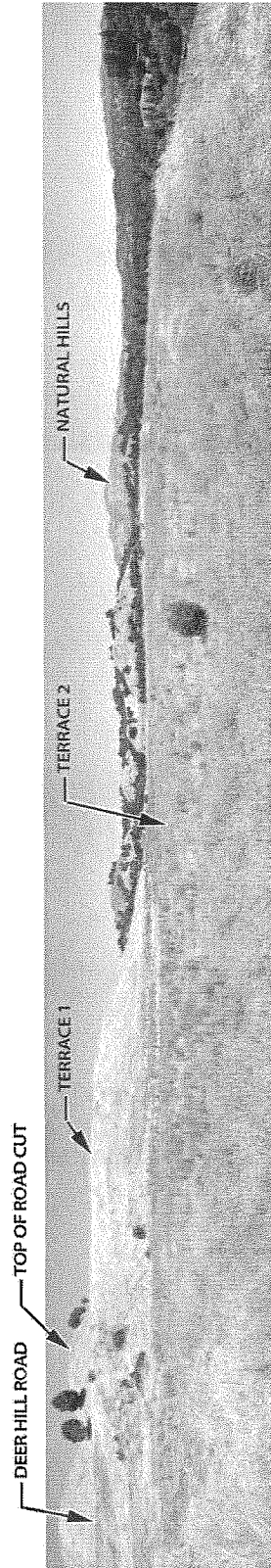

View C

THE TERRACES OF LAFAYETTE  
 APN: 021-010-0271 | 1270 DEER HILL ROAD, LAFAYETTE, CALIF. 94501, 94508  
**ON-SITE PHOTOS**

AMD FAMILY TRUST | O'BRIEN LAND COMPANY, LLC. | **OLCA** ARCHITECTS

ORG1-63  
 cont.

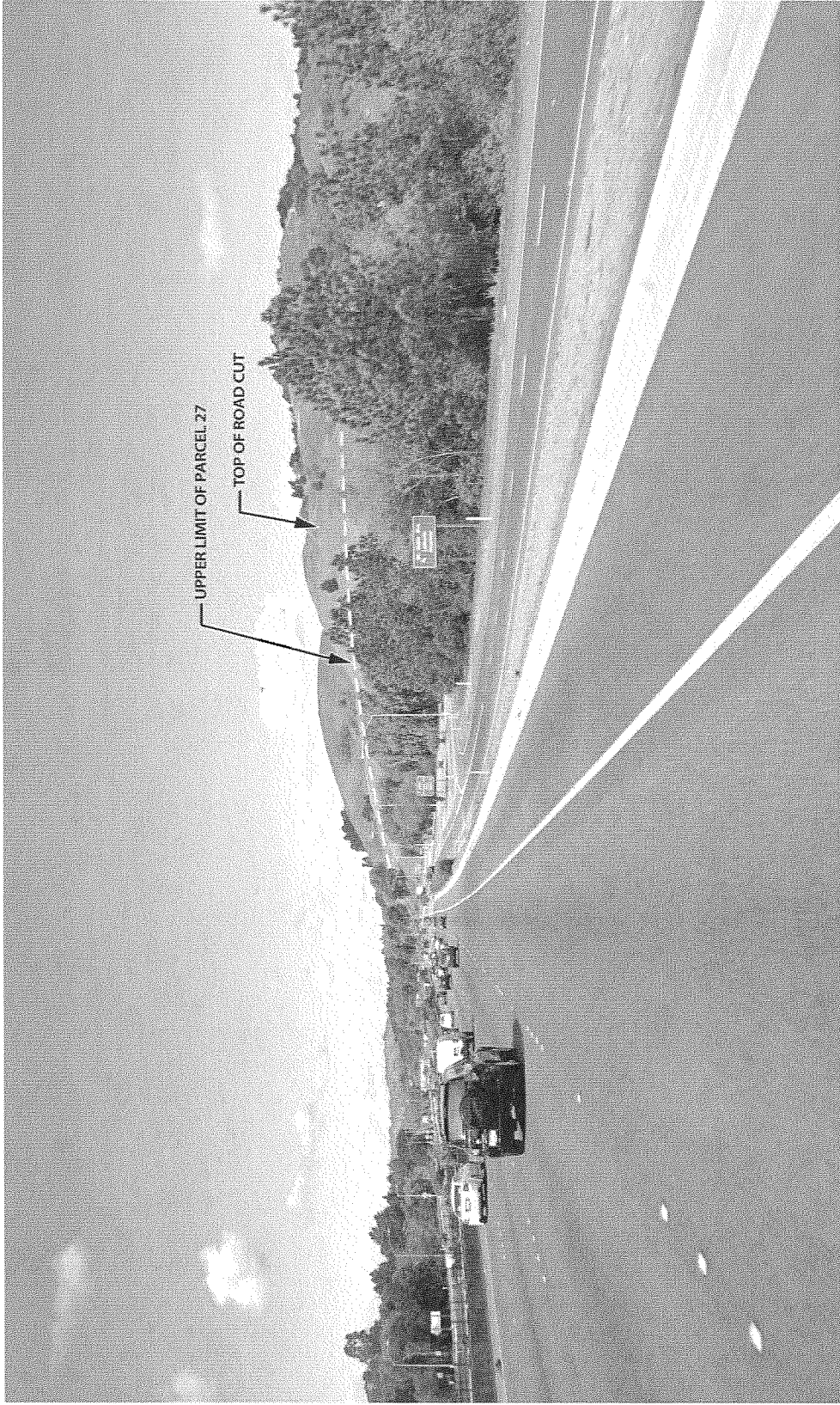

THE TERRACES OF LAFAYETTE  
APN 523-0-027 | 523 INDIAN VALLEY, LAFAYETTE, CALIFORNIA, 94548

OFF-SITE PHOTOS: VIEW FROM HIGHWAY 24 WESTBOUND

AMD FAMILY TRUST

O'BRIEN LAND COMPANY, L.L.C.



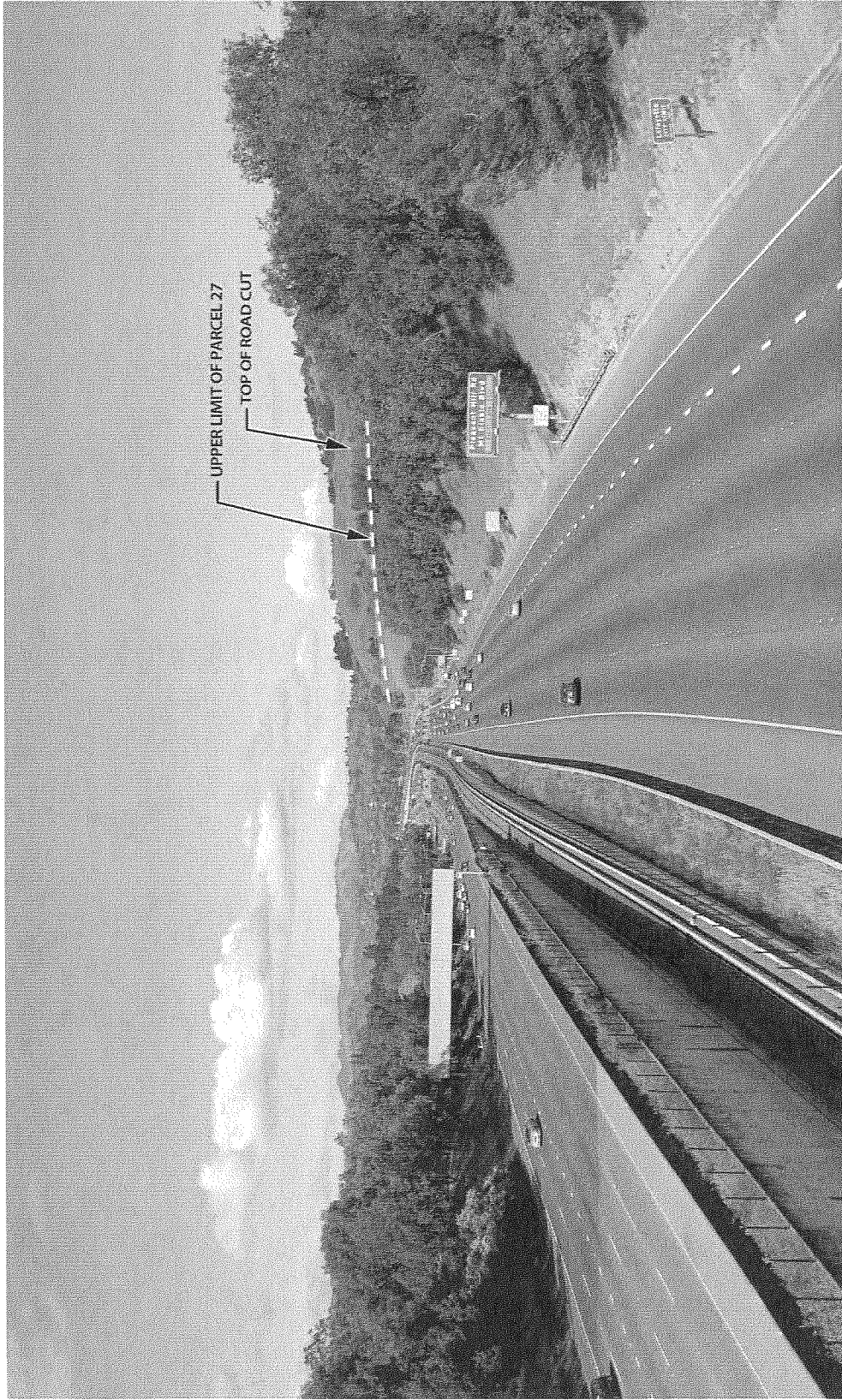

THE TERRACES OF LAFAYETTE  
APN 032-040-027 | 5270 N. 8th St., Lafayette, CA 94508

OFF-SITE PHOTOS: VIEW FROM EL CURTOLA BRIDGE

AMD FAMILY TRUST

O'BRIEN LAND COMPANY, L.L.C.



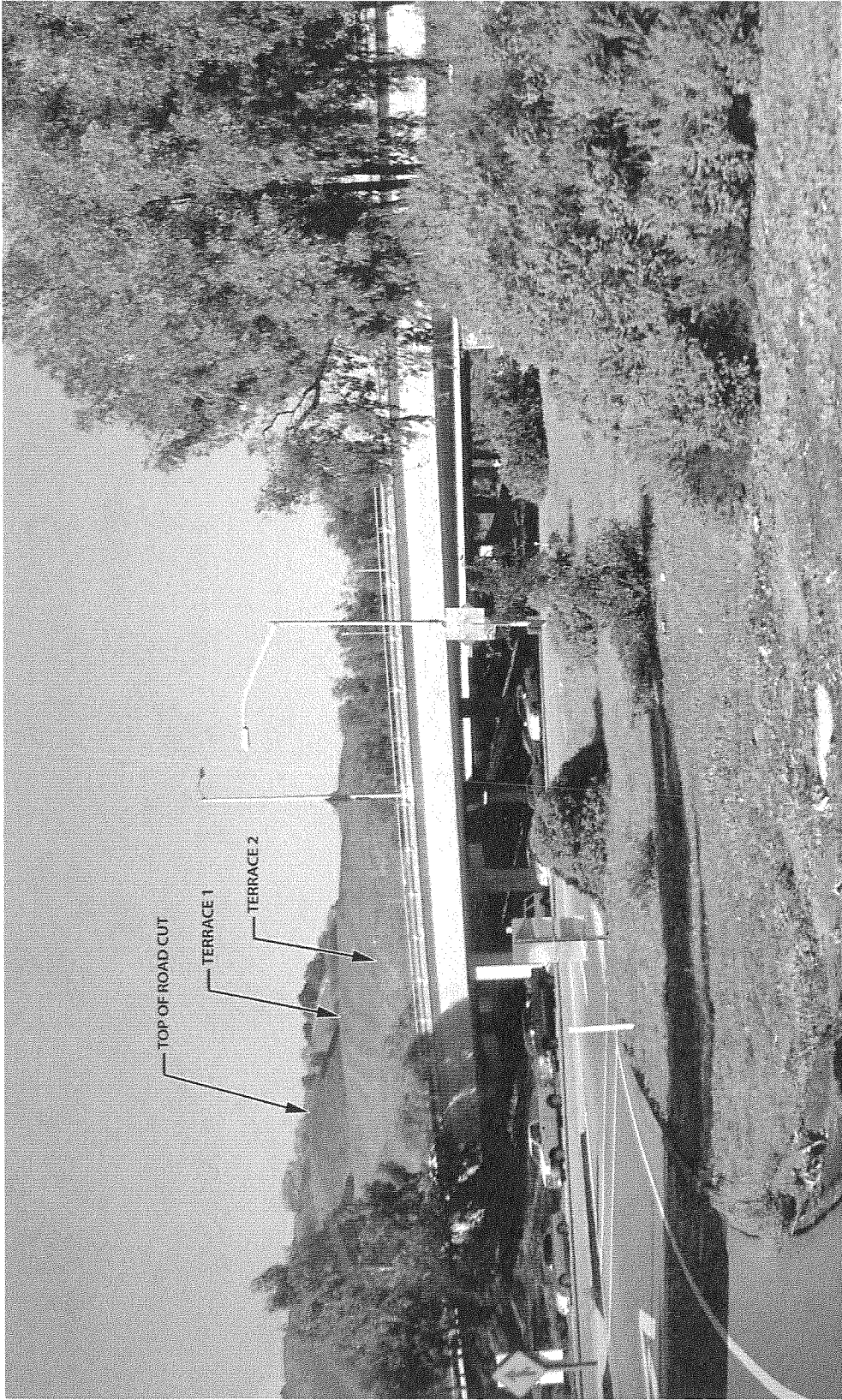

THE TERRACES OF LAFAYETTE  
APN 3125-000007 | 1270 WYAK RD W, LAFAYETTE, CALIFORNIA 94549



AMD FAMILY TRUST | O'BRIEN LAND COMPANY, LLC.

OFF-SITE PHOTOS: VIEW FROM OLD TUNNEL AND PLEASANT HILL ROADS

ORG1-63  
cont.